



# Spare Parts List

**VOGELSANG**



**TUnit MP Pro DSR-V40**

Machine Type

**YTS0000013**

Part Number

## Table of Contents

Drw-Pos.	ERP-Pos.	Denomination	Quantity	Part	Page
10	10	TUnit MP Base V40	1.000 St	IBA3349	5
20	20	T-Pole TUnit MP/SP DSR	1.000 St	GYS0012	10
30	30	Local control VOS-Touch	1.000 St	PRO0000092	
40	40	TUnit MP, Control Pro DSR	1.000 St	EPM0000529	13
50	50	Signal Column 24 V Signal Color Clear / Red / Yellow /	1.000 St	ELE0000034	
60	60	Water Piping Set Clamp Connection-Ø 32 mm	1.000 St	IBA0001482	14
70	70	Suction Device Hose Tail DN 50 Drainage Coupling 50 mm - 65	1.000 St	IBA0001486	16
80	80	Water Piping Set Clamp Connection-Ø 32 mm	1.000 St	IBA0001564	18
90	90	Water Supply Coupling EasyConnect Pro	1.000 St	NYK.050.TH	20
100	100	Suction coupling EasyConnect Pro Kamlock 3 inch Stainless	1.000 St	NYK0000021	21
110	110	Flow Control FlowMeter	1.000 St	PRO0000095	
120	120	Pressure sensor -1 bar ... +1 bar	1.000 St	NDR0000012	
130	130	Temperature Sensor LP7-PT100-3L-5.0 Cable lug Ø	2.000 St	SSS0000011	
140	140	Sensor-Actuator Patch Cord Number of poles: 5, 2,0 m	1.000 St	EKK0196	
150	150	Guide Pulley TUnit	1.000 St	GYA0010	23
160	160	Guide Pulley TUnit	1.000 St	GYA0011	24
170	170	Hose Kit Water Hose, DN 25, 7,8 m	1.000 St	GSC0000011	25
180	180	Hose Kit Water Hose, DN 25, 8,5 m	1.000 St	GSC0000012	26
190	190	Hose Kit Spiral Hose, DN 50, 8,2 m	1.000 St	GSC0382	27
200	200	Swivel Adapter TUnit MP/TUnit SP	1.000 St	IBA4578	28
210	210	Locking Set TUnit MP	1.000 St	IBA3347	29
220	220	Pipeworks TUnit MP	2.000 St	IBA0001152	30
230	230	Pipeworks TUnit MP	1.000 St	IBA4470	31
240	240	Finned Heater 250 W, 230 V	2.000 St	PRO0004	
250	250	Holder TUnit MP	1.000 St	IBA2631	33
260	260	Cover 2 mm Steel Sheet, Galvanized	1.000 St	RYL.099.N2	
270	270	Lamp holder TUnit MP/TUnit SP	1.000 St	IBA0001507	34
280	280	Cap Trail TS 35 35 mm x 7,5 mm x 75 mm	2.000 St	EPM0727	
290	290	T-Fitting, Plastics Ø 50 mm x Ø 50 mm x Ø 50 mm,	1.000 St	HPT.400	
300	300	Reducer Ø 75 mm x Ø 50 mm	1.000 St	HPZ0023	

## Table of Contents

Drw-Pos.	ERP-Pos.	Denomination	Quantity	Part	Page
310	310	Reducer DN 50 x DN 30	1.000 St	HPZ0043	
320	320	Bolt Set TUnit MP	1.000 St	IBA3538	35
330	330	Bolt Set TUnit MP/SP	1.000 St	IBA4542	36
340	340	Insulation TUnit MP	1.000 St	ISO0265	
350	350	Cap Nut M 6 , DIN 1587	4.000 St	NMH.005	
360	360	Hexagon Nut M 4 , DIN 934	4.000 St	NMS.025	
370	370	Blind Rivet A Ø 3,2 mm x 8 mm	4.000 St	NNI0002	
380	380	Cylinder Head Bolt M 6 x 20 mm ISO 4762	4.000 St	NSI.052	
390	390	Pan Head Bolt M 4 x 12 mm ISO 7380	4.000 St	NSI.140	
400	400	Pan Head Bolt M 8 x 10 mm ISO 7380	3.000 St	NSI0085	
410	410	Clamping Jaws Maximum Clamping Range: 35 mm	2.000 St	NSS0069	
420	420	Rubber Plug Ø 25 mm x	2.000 St	NST0000017	
430	430	Covering Rosette Ø 90 mm	1.000 St	NST0001	
440	440	Lamellar Plug Ø 20 mm x 11 mm x 1-2 mm	1.000 St	NST0004	
450	450	Lamellar Plug Ø 15 mm x 11 mm x 1-2 mm	2.000 St	NST0005	
460	460	Washer A Ø 6,4 mm x Ø 12 mm x 1,6 mm	4.000 St	NUS.002	
470	470	Washer A Ø 4,3 mm x Ø 9 mm x 0,8 mm	8.000 St	NUS.069	
480	480	Name Plate 70 x 60 x 0,8 mm General	1.000 St	VAU0120	
490	490	Sticker Parts Kit TUnit MP Plus / Pro	1.000 St	VAU0223	37
500	500	Sewer Pipe Ø 75 mm x 2,0 mm 5000 mm	0.050 m	HPR0040	
510	510	Spiral Hose DN 25 x Ø 25 mm 4 mm 50000 mm	0.300 m	HSC0203	
520	520	Insulation Hose Ø 42 mm x 25 mm x 2 m	0.750 m	ISO0000076	
530	530	Velcro tape Bundled Black x 50 mm -15 °C ... +140 °C Adhesive	1.800 m	VPA0000028	

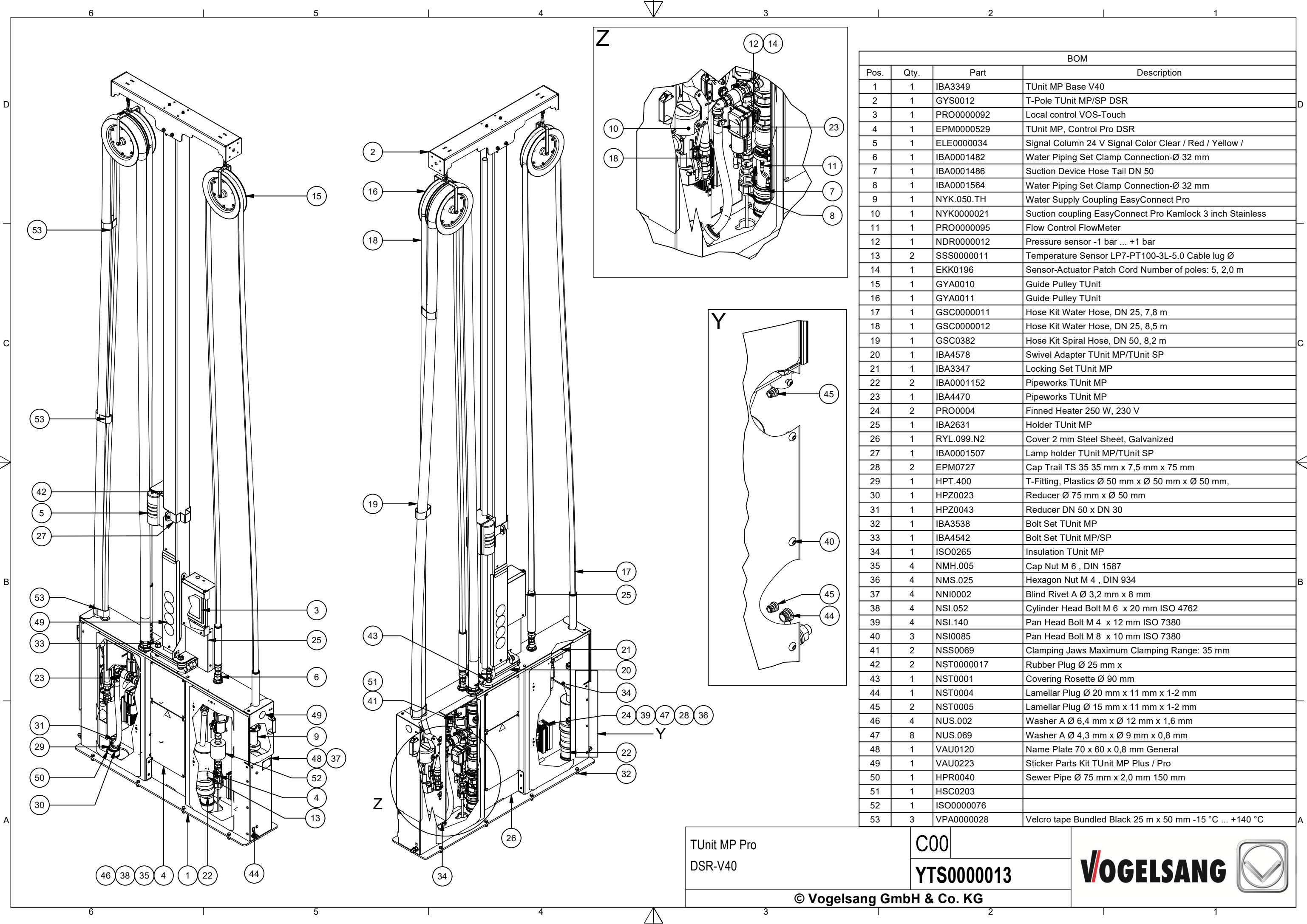

BOM			
Pos.	Qty.	Part	Description
1	1	IBA3349	TUnit MP Base V40
2	1	GYS0012	T-Pole TUnit MP/SP DSR
3	1	PRO0000092	Local control VOS-Touch
4	1	EPM0000529	TUnit MP, Control Pro DSR
5	1	ELE0000034	Signal Column 24 V Signal Color Clear / Red / Yellow /
6	1	IBA0001482	Water Piping Set Clamp Connection-Ø 32 mm
7	1	IBA0001486	Suction Device Hose Tail DN 50
8	1	IBA0001564	Water Piping Set Clamp Connection-Ø 32 mm
9	1	NYK.050.TH	Water Supply Coupling EasyConnect Pro
10	1	NYK0000021	Suction coupling EasyConnect Pro Kamlock 3 inch Stainless
11	1	PRO0000095	Flow Control FlowMeter
12	1	NDR0000012	Pressure sensor -1 bar ... +1 bar
13	2	SSS0000011	Temperature Sensor LP7-PT100-3L-5.0 Cable lug Ø
14	1	EKK0196	Sensor-Actuator Patch Cord Number of poles: 5, 2,0 m
15	1	GYA0010	Guide Pulley TUnit
16	1	GYA0011	Guide Pulley TUnit
17	1	GSC0000011	Hose Kit Water Hose, DN 25, 7,8 m
18	1	GSC0000012	Hose Kit Water Hose, DN 25, 8,5 m
19	1	GSC0382	Hose Kit Spiral Hose, DN 50, 8,2 m
20	1	IBA4578	Swivel Adapter TUnit MP/TUnit SP
21	1	IBA3347	Locking Set TUnit MP
22	2	IBA0001152	Pipeworks TUnit MP
23	1	IBA4470	Pipeworks TUnit MP
24	2	PRO0004	Finned Heater 250 W, 230 V
25	1	IBA2631	Holder TUnit MP
26	1	RYL.099.N2	Cover 2 mm Steel Sheet, Galvanized
27	1	IBA0001507	Lamp holder TUnit MP/TUnit SP
28	2	EPM0727	Cap Trail TS 35 35 mm x 7,5 mm x 75 mm
29	1	HPT.400	T-Fitting, Plastics Ø 50 mm x Ø 50 mm x Ø 50 mm,
30	1	HPZ0023	Reducer Ø 75 mm x Ø 50 mm
31	1	HPZ0043	Reducer DN 50 x DN 30
32	1	IBA3538	Bolt Set TUnit MP
33	1	IBA4542	Bolt Set TUnit MP/SP
34	1	ISO0265	Insulation TUnit MP
35	4	NMH.005	Cap Nut M 6 , DIN 1587
36	4	NMS.025	Hexagon Nut M 4 , DIN 934
37	4	NNI0002	Blind Rivet A Ø 3,2 mm x 8 mm
38	4	NSI.052	Cylinder Head Bolt M 6 x 20 mm ISO 4762
39	4	NSI.140	Pan Head Bolt M 4 x 12 mm ISO 7380
40	3	NSI0085	Pan Head Bolt M 8 x 10 mm ISO 7380
41	2	NSS0069	Clamping Jaws Maximum Clamping Range: 35 mm
42	2	NST0000017	Rubber Plug Ø 25 mm x
43	1	NST0001	Covering Rosette Ø 90 mm
44	1	NST0004	Lamellar Plug Ø 20 mm x 11 mm x 1-2 mm
45	2	NST0005	Lamellar Plug Ø 15 mm x 11 mm x 1-2 mm
46	4	NUS.002	Washer A Ø 6,4 mm x Ø 12 mm x 1,6 mm
47	8	NUS.069	Washer A Ø 4,3 mm x Ø 9 mm x 0,8 mm
48	1	VAU0120	Name Plate 70 x 60 x 0,8 mm General
49	1	VAU0223	Sticker Parts Kit TUnit MP Plus / Pro
50	1	HPR0040	Sewer Pipe Ø 75 mm x 2,0 mm 150 mm
51	1	HSC0203	
52	1	ISO0000076	
53	3	VPA0000028	Velcro tape Bundled Black 25 m x 50 mm -15 °C ... +140 °C

TUnit MP Pro  
DSR-V40

C00

YTS0000013

© Vogelsang GmbH & Co. KG

**VOGELSANG**



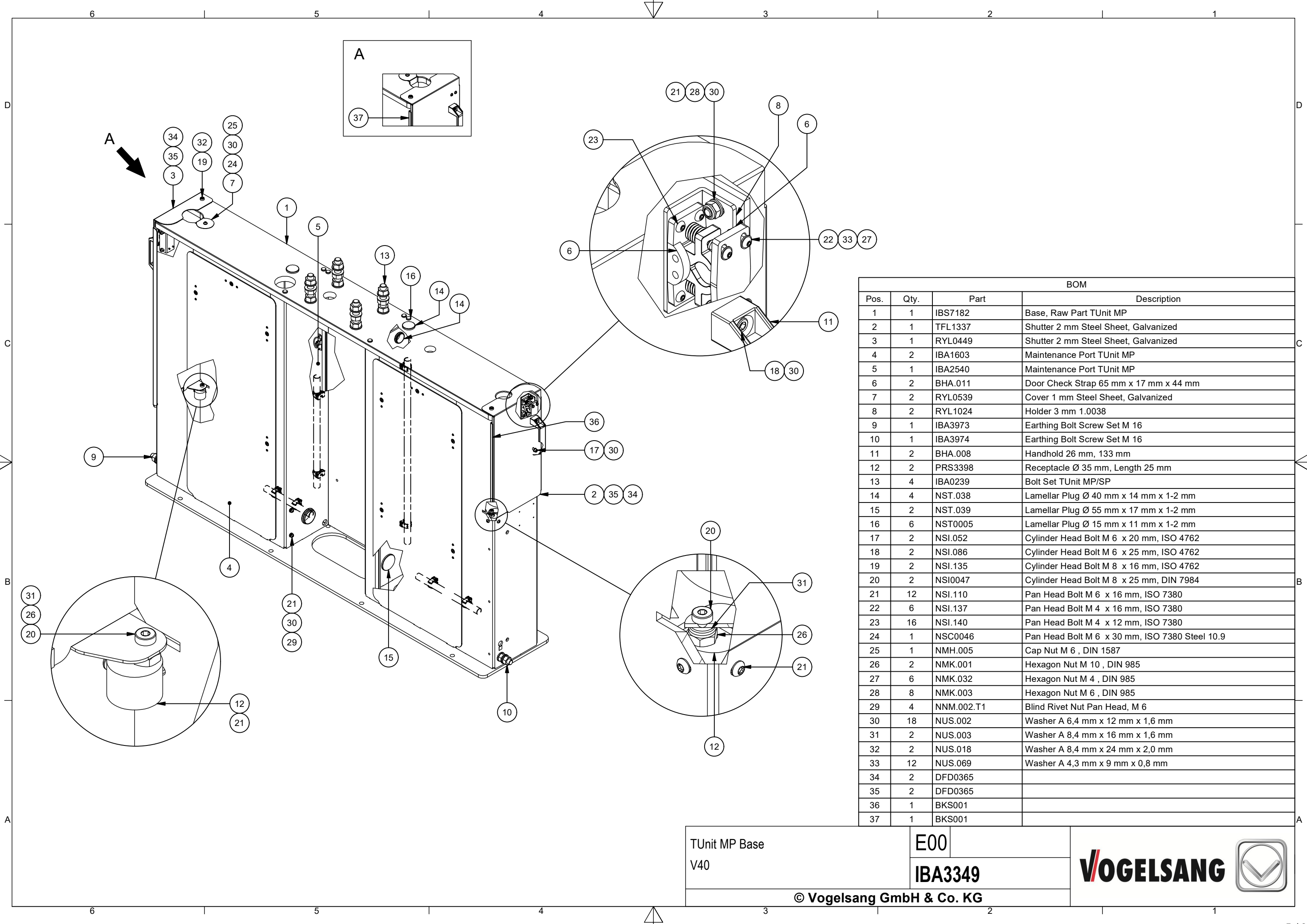

BOM			
Pos.	Qty.	Part	Description
1	1	IBS7182	Base, Raw Part TUnit MP
2	1	TFL1337	Shutter 2 mm Steel Sheet, Galvanized
3	1	RYL0449	Shutter 2 mm Steel Sheet, Galvanized
4	2	IBA1603	Maintenance Port TUnit MP
5	1	IBA2540	Maintenance Port TUnit MP
6	2	BHA.011	Door Check Strap 65 mm x 17 mm x 44 mm
7	2	RYL0539	Cover 1 mm Steel Sheet, Galvanized
8	2	RYL1024	Holder 3 mm 1.0038
9	1	IBA3973	Earthing Bolt Screw Set M 16
10	1	IBA3974	Earthing Bolt Screw Set M 16
11	2	BHA.008	Handhold 26 mm, 133 mm
12	2	PRS3398	Receptacle Ø 35 mm, Length 25 mm
13	4	IBA0239	Bolt Set TUnit MP/SP
14	4	NST.038	Lamellar Plug Ø 40 mm x 14 mm x 1-2 mm
15	2	NST.039	Lamellar Plug Ø 55 mm x 17 mm x 1-2 mm
16	6	NST0005	Lamellar Plug Ø 15 mm x 11 mm x 1-2 mm
17	2	NSI.052	Cylinder Head Bolt M 6 x 20 mm, ISO 4762
18	2	NSI.086	Cylinder Head Bolt M 6 x 25 mm, ISO 4762
19	2	NSI.135	Cylinder Head Bolt M 8 x 16 mm, ISO 4762
20	2	NSI0047	Cylinder Head Bolt M 8 x 25 mm, DIN 7984
21	12	NSI.110	Pan Head Bolt M 6 x 16 mm, ISO 7380
22	6	NSI.137	Pan Head Bolt M 4 x 16 mm, ISO 7380
23	16	NSI.140	Pan Head Bolt M 4 x 12 mm, ISO 7380
24	1	NSC0046	Pan Head Bolt M 6 x 30 mm, ISO 7380 Steel 10.9
25	1	NMH.005	Cap Nut M 6 , DIN 1587
26	2	NMK.001	Hexagon Nut M 10 , DIN 985
27	6	NMK.032	Hexagon Nut M 4 , DIN 985
28	8	NMK.003	Hexagon Nut M 6 , DIN 985
29	4	NNM.002.T1	Blind Rivet Nut Pan Head, M 6
30	18	NUS.002	Washer A 6,4 mm x 12 mm x 1,6 mm
31	2	NUS.003	Washer A 8,4 mm x 16 mm x 1,6 mm
32	2	NUS.018	Washer A 8,4 mm x 24 mm x 2,0 mm
33	12	NUS.069	Washer A 4,3 mm x 9 mm x 0,8 mm
34	2	DFD0365	
35	2	DFD0365	
36	1	BKS001	
37	1	BKS001	

TUnit MP Base  
V40

E00

IBA3349

© Vogelsang GmbH & Co. KG

**VOGELSANG**

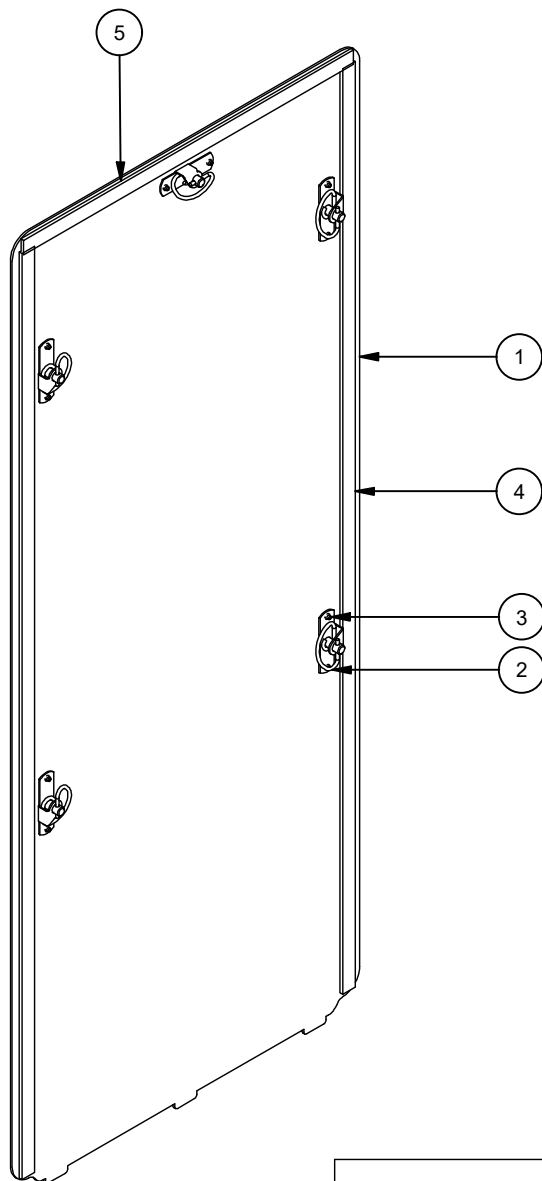

BOM			
Pos.	Qty.	Part	Description
1	1	TFL1338	Maintenance Port 2 mm Steel Sheet, Galvanized
2	5	NYV0000027	Compressive Fastener Hexagon Socket
3	10	NNI0000001	Blind Rivet C Ø 3,2 mm x 11,5 mm 3,0 mm - 5,0 mm Stainless
4	2	DFD0365	
5	1	DFD0365	

Maintenance Port  
TUnit MP

B00

IBA1603

© Vogelsang GmbH & Co. KG

**VOGELSANG**



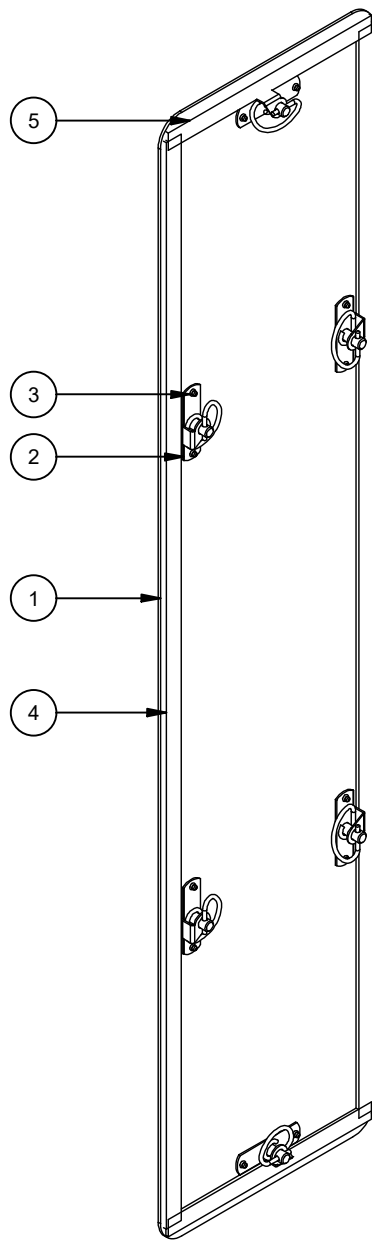

BOM			
Pos.	Qty.	Part	Description
1	1	TFL3081	Maintenance Port 2 mm Steel Sheet, Galvanized
2	6	NYV0000027	Compressive Fastener Hexagon Socket
3	12	NNI0000001	Blind Rivet C Ø 3,2 mm x 11,5 mm 3,0 mm - 5,0 mm Stainless
4	2	DFD0365	
5	2	DFD0365	

Maintenance Port TUnit MP	B00	
	IBA2540	
	© Vogelsang GmbH & Co. KG	

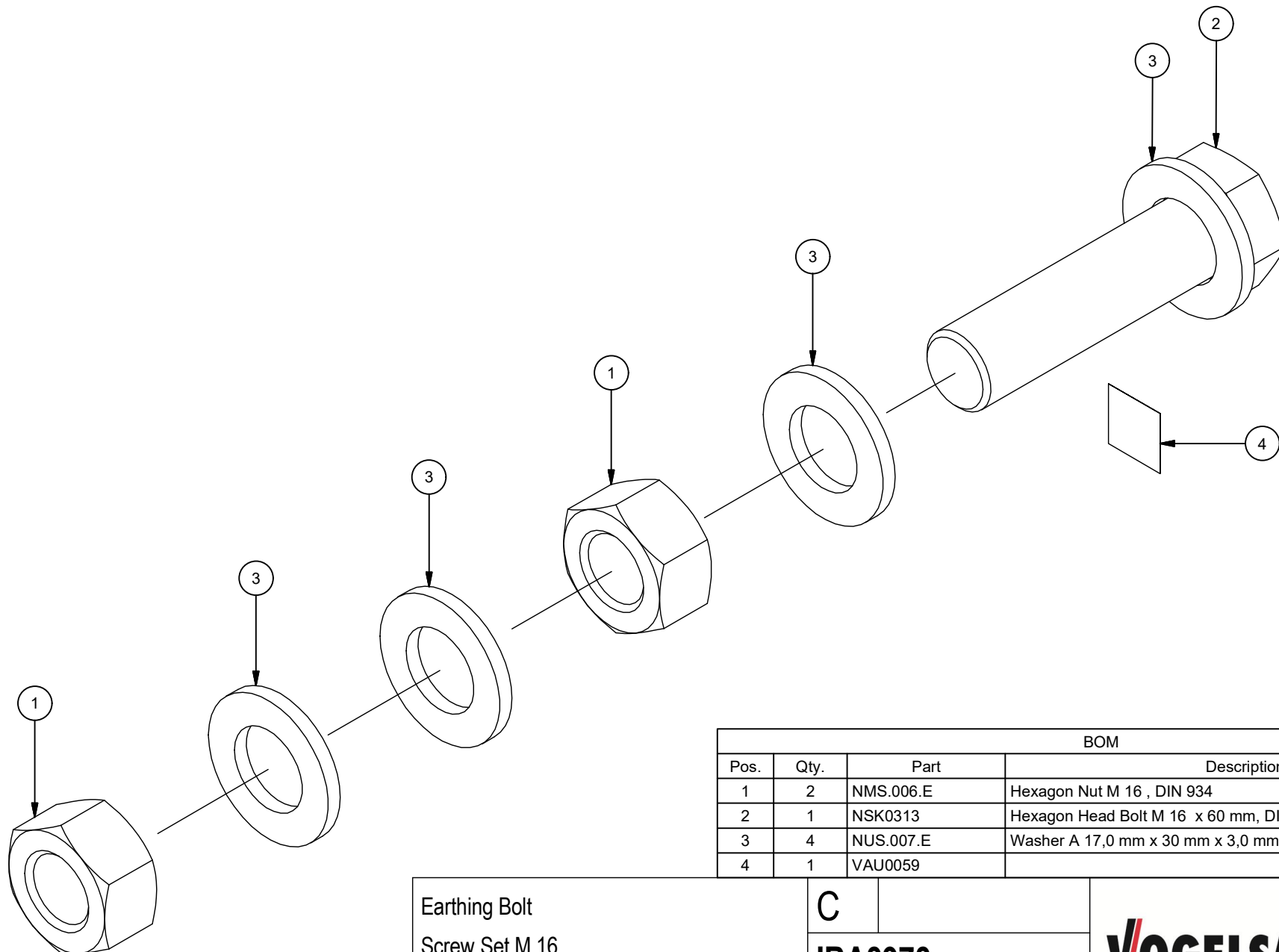

BOM			
Pos.	Qty.	Part	Description
1	2	NMS.006.E	Hexagon Nut M 16 , DIN 934
2	1	NSK0313	Hexagon Head Bolt M 16 x 60 mm, DIN 933
3	4	NUS.007.E	Washer A 17,0 mm x 30 mm x 3,0 mm
4	1	VAU0059	

Earthing Bolt  
Screw Set M 16

C

IBA3973

© Vogelsang GmbH & Co. KG

**Vogelsang**



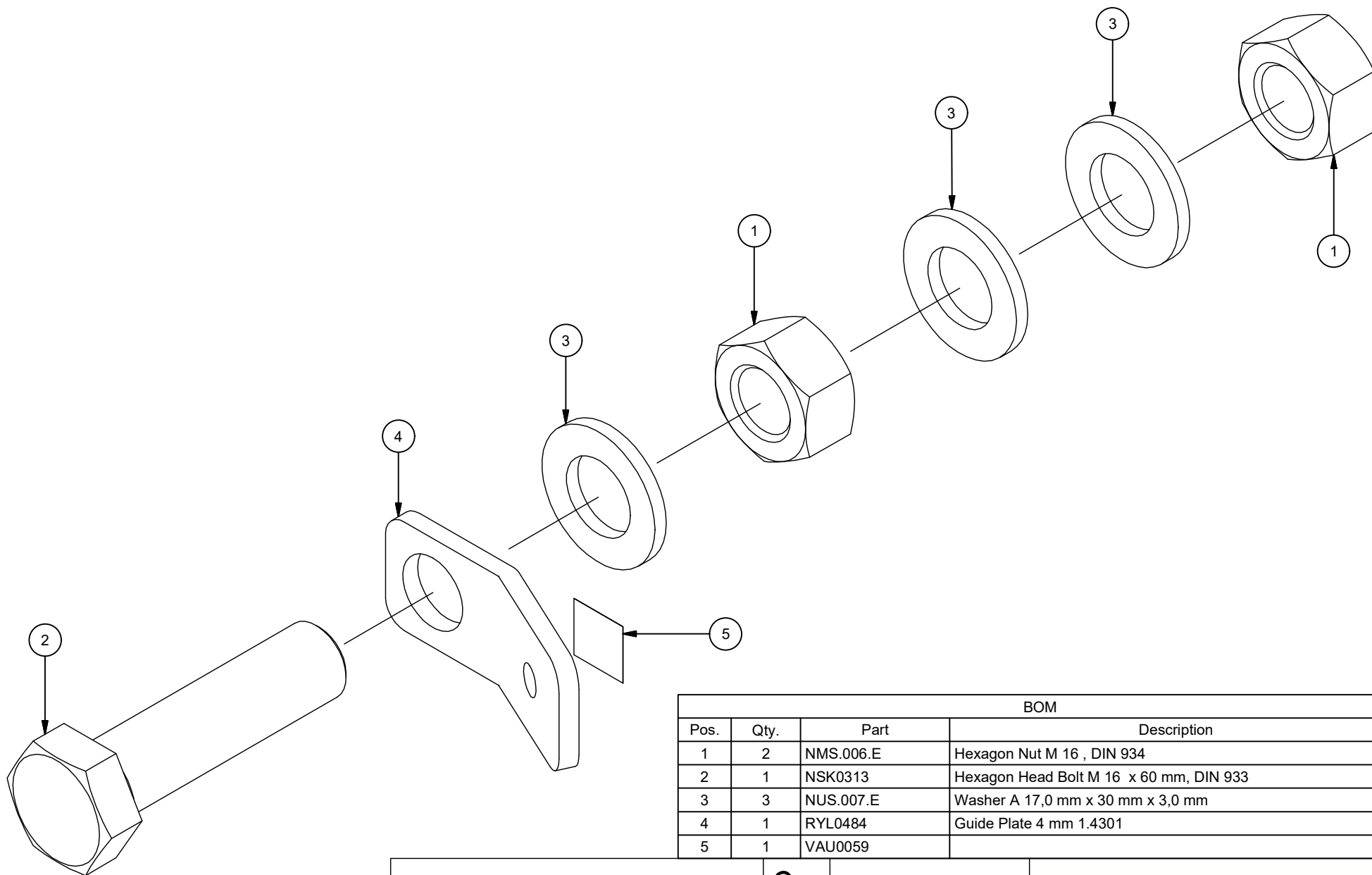

BOM			
Pos.	Qty.	Part	Description
1	2	NMS.006.E	Hexagon Nut M 16 , DIN 934
2	1	NSK0313	Hexagon Head Bolt M 16 x 60 mm, DIN 933
3	3	NUS.007.E	Washer A 17,0 mm x 30 mm x 3,0 mm
4	1	RYL0484	Guide Plate 4 mm 1.4301
5	1	VAU0059	

Earthing Bolt  
Screw Set M 16

C

IBA3974

© Vogelsang GmbH & Co. KG

**VOGELSANG**



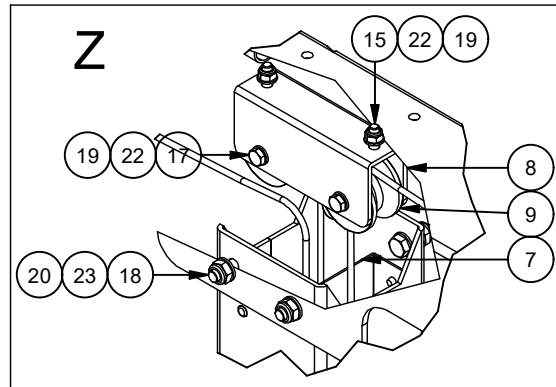
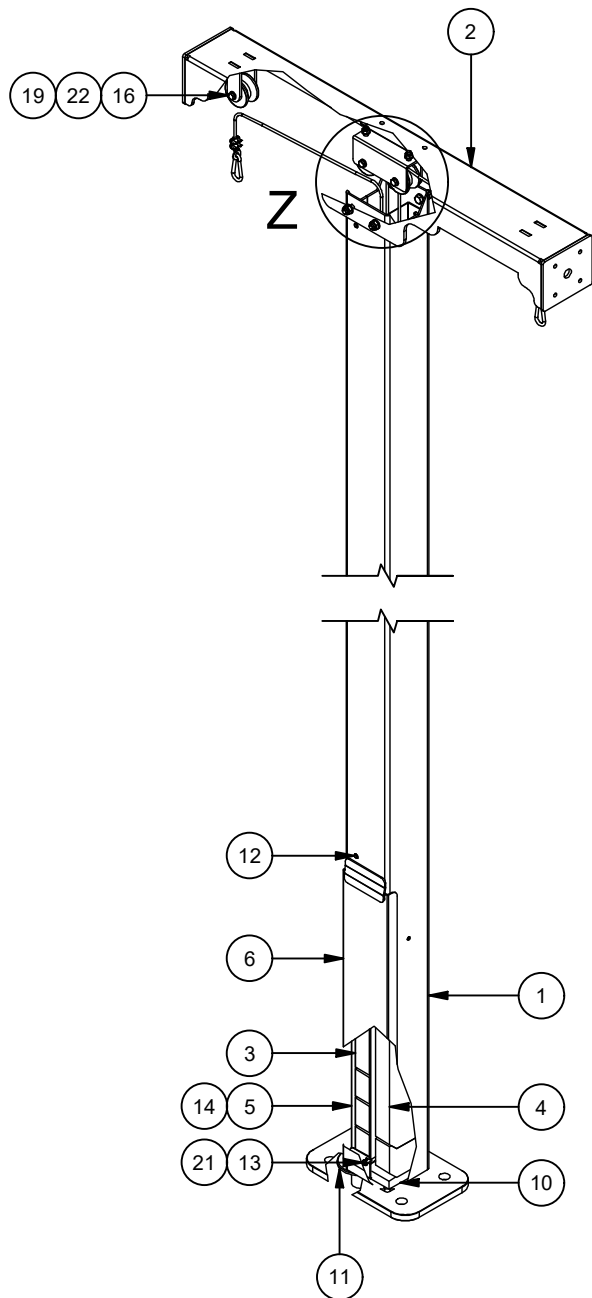

BOM			
Pos.	Qty.	Part	Description
1	1	IBS0695	T-Pole Steel
2	1	IBS0694	T-Pole Head Steel
3	1	IBA1664	Hose Retraction Device Weight 18,5 kg
4	1	IBA0205	Hose Retraction Device Weight 14,5 kg
5	1	GEW0010	Weight Weight 5 kg
6	1	RYL0364	Cover 2 mm Steel Sheet, Galvanized
7	1	IBW0000476	Separation Plate 1.0226
8	1	RYL0362	Holder 4 mm 1.0038
9	4	NSR0006	Cable Pulley Ø 60 mm Groove Ball Bearing on Both Sides
10	2	DFD0022	Water-Cut Part Material Thickness 20 mm
11	1	NST0001	Covering Rosette Ø 90 mm
12	5	NNI.006	Blind Rivet C Ø 4,8 mm x 12 mm
13	1	NSI.110	Pan Head Bolt M 6 x 16 mm, ISO 7380
14	2	NSI.079	Countersunk Bolt M 8 x 25 mm, ISO 10642
15	2	NSK.019	Hexagon Head Bolt M 8 x 25 mm, DIN 933
16	2	NSK.024	Hexagon Head Bolt M 8 x 60 mm, DIN 931
17	2	NSK.043	Hexagon Head Bolt M 8 x 55 mm, DIN 931
18	4	NSK.001	Hexagon Head Bolt M 10 x 30 mm, DIN 933
19	6	NMK.004	Hexagon Nut M 8 , DIN 985
20	4	NMK.001	Hexagon Nut M 10 , DIN 985
21	1	NUS.002	Washer A 6,4 mm x 12 mm x 1,6 mm
22	12	NUS.003	Washer A 8,4 mm x 16 mm x 1,6 mm
23	8	NUS.004	Washer A 10,5 mm x 20 mm x 2,0 mm

T-Pole  
TUnit MP/SP DSR

B00

GYS0012

© Vogelsang GmbH & Co. KG

**VOGELSANG**



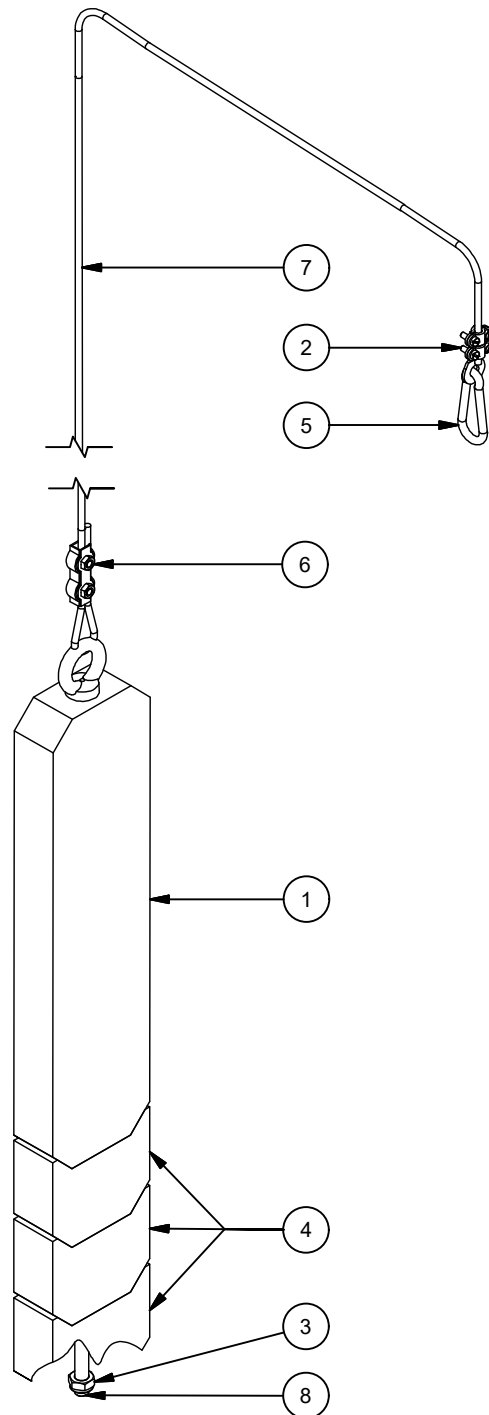

BOM			
Pos.	Qty.	Part	Description
1	1	GYA0016	Weight Weight 12,5 kg
2	1	NKK.001	Bolted Cable Lug 16 - 25 mm², M5
3	1	NMK.001	Hexagon Nut M 10 , DIN 985
4	3	RYL0381	Weight Weight 2 kg
5	1	SKB.002	Snap Hook 60 mm x 6 mm
6	1	TMB.016	Duplex Clip 5 mm
7	1	ZHNS001.4200	
8	1	ZNGS001.0250	

Hose Retraction Device  
Weight 18,5 kg

B

IBA1664

© Vogelsang GmbH & Co. KG

**VOGELSANG**





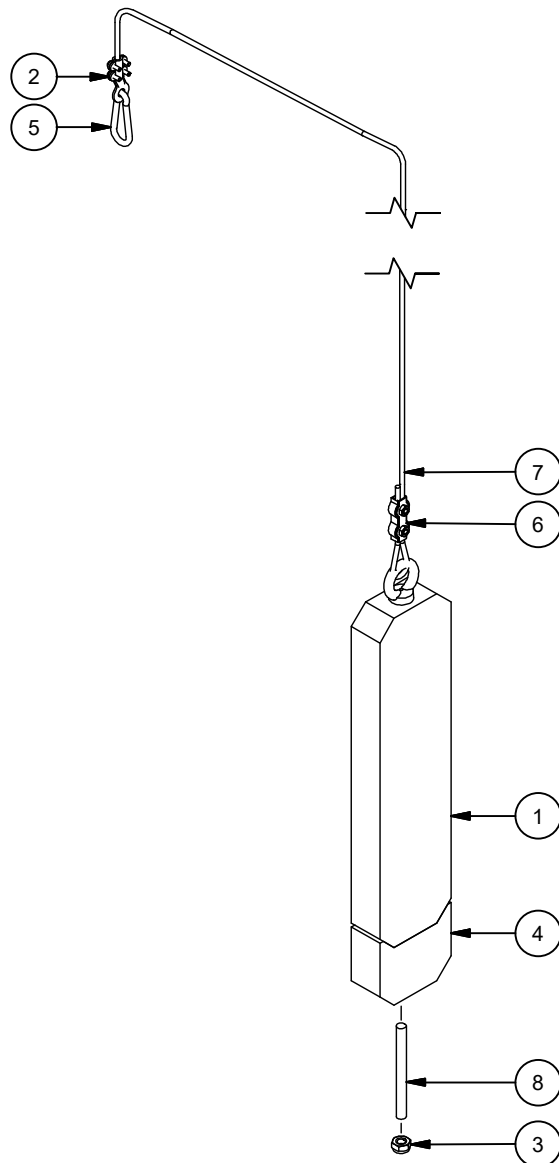

BOM			
Pos.	Qty.	Part	Description
1	1	GYA0016	Weight Weight 12,5 kg
2	1	NKK.001	Bolted Cable Lug 16 - 25 mm², M5
3	1	NMK.001	Hexagon Nut M 10 , DIN 985
4	1	RYL0381	Weight Weight 2 kg
5	1	SKB.002	Snap Hook 60 mm x 6 mm
6	1	TMB.016	Duplex Clip 5 mm
7	1	ZHNS.001.5000	
8	1	ZNGS.001.0110	

Hose Retraction Device  
Weight 14,5 kg

B

IBA0205

© Vogelsang GmbH & Co. KG

**VOGELSANG**



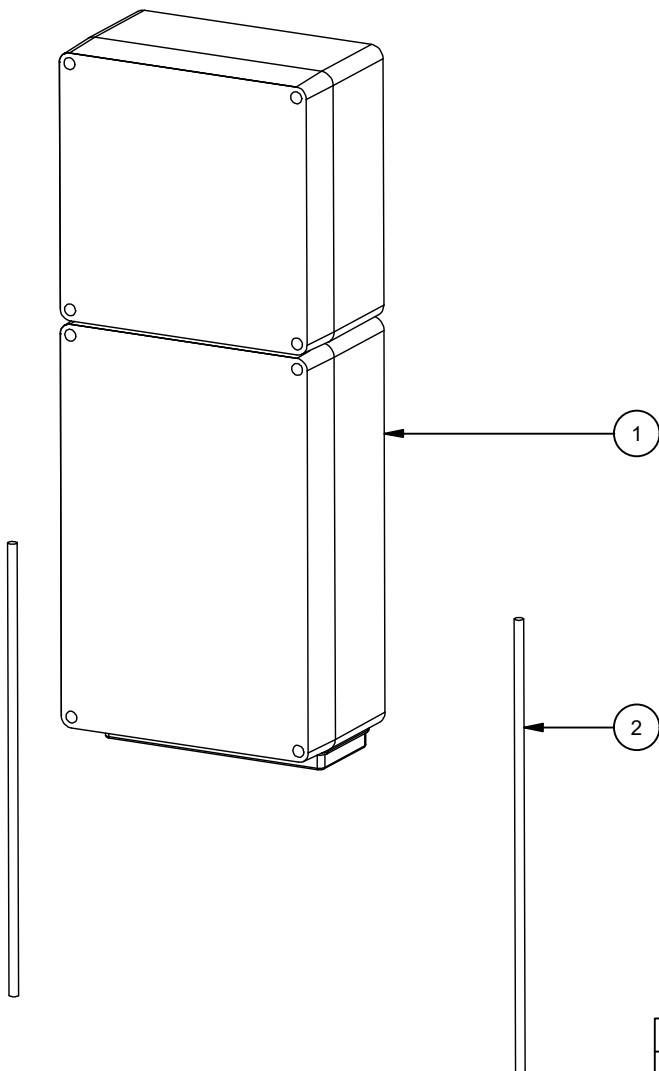

BOM			
Pos.	Qty.	Part	Description
1	1	EPM0000530	Control Cabinet 750 mm x 300 mm x 170 mm
2	2	EPM.084	Trace Heating 10 W/m, 230 V

TUnit MP, Control Pro  
DSR

C00

EPM0000529

© Vogelsang GmbH & Co. KG

**VOGELSANG**



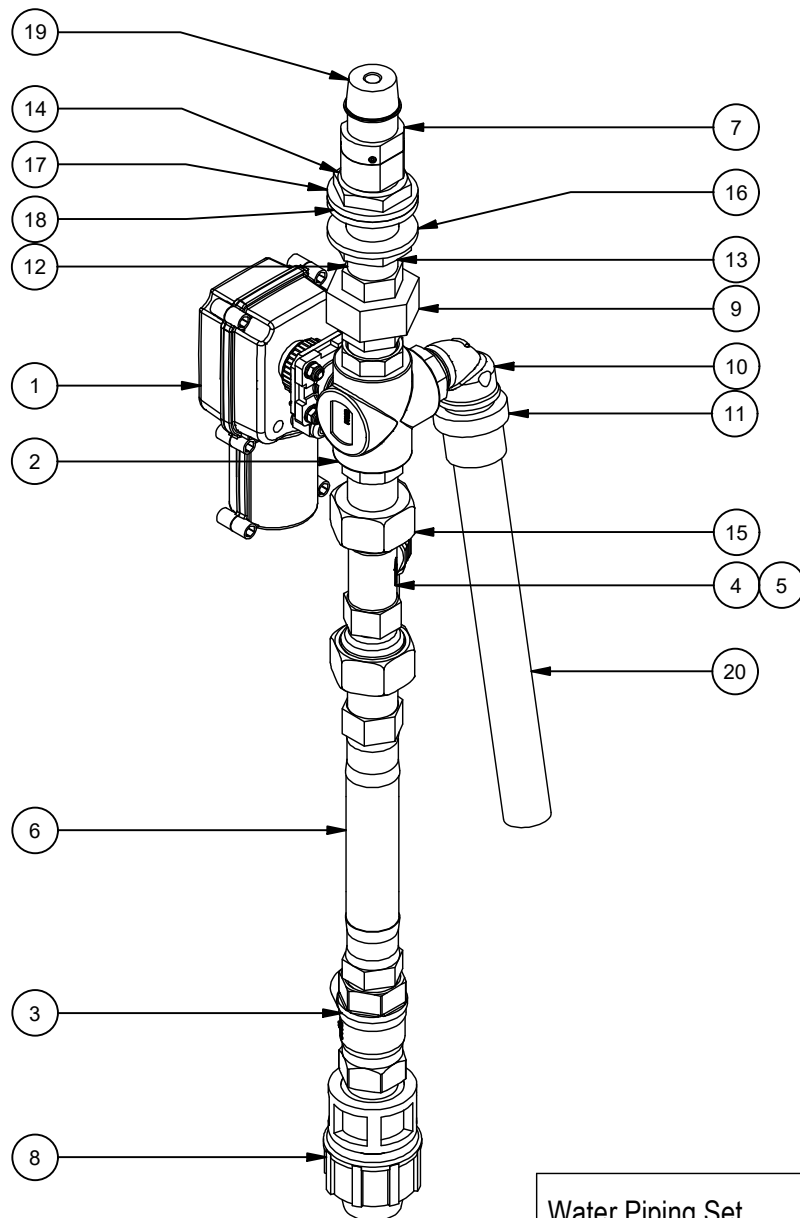

BOM			
Pos.	Qty.	Part	Description
1	1	GHN0129	Electrical Rotary Drive 12 V, IP54
2	1	GHN0000017	Body Ball Valve 3-Way Ball Valve
3	1	GHN0082	2-Way Ball Valve 1 inch, IG - IG, Brass Butterfly Handle,
4	1	SDW0000014	Flow Meter DN 25, MT 1 1/4 inch , Optional Plastics, Huba
5	1	EKK0196	Sensor-Actuator Patch Cord Number of poles: 5, 2,0 m
6	1	HSC.059	Armoured Hose DN 25, 1 inch FT - MT
7	1	GDG0022	Swivel Joint Vogelsang DN 25, 1.4301
8	1	HPB0203	Clamp Connection Ø 32 mm - 1 inch
9	1	NVE.039	Straight Coupling FT 1 inch - MT 1 inch
10	1	NWE.207	Angle 90° 1 inch FT - 1 inch MT
11	1	HPB.037	Adapter Nipple Ø 32 mm x Ø 40 mm x 1 inch
12	1	NVE.079	Pipe Nipple 1 inch x 100 mm,
13	1	NVE.054	Pipe Nut G 1 inch , DIN 431 Form B
14	1	NVE.054.E	Pipe Nut G 1 inch , DIN 431
15	2	NVE0159	Reducer 1 1/4 inch FT - 1 inch MT
16	1	NUS.025	Washer B Ø 34 mm x Ø 60 mm x 5 mm
17	1	NUS0079	Washer B Ø 34 mm x Ø 60 mm x 5 mm
18	1	NUS0150	Washer A Ø 34 mm x Ø 60 mm x 5 mm
19	1	NST0089	End Cap Ø 33,4 mm
20	1	HPR.018	

Water Piping Set  
Clamp Connection-Ø 32 mm

A00

IBA0001482

© Vogelsang GmbH & Co. KG

**Vogelsang**



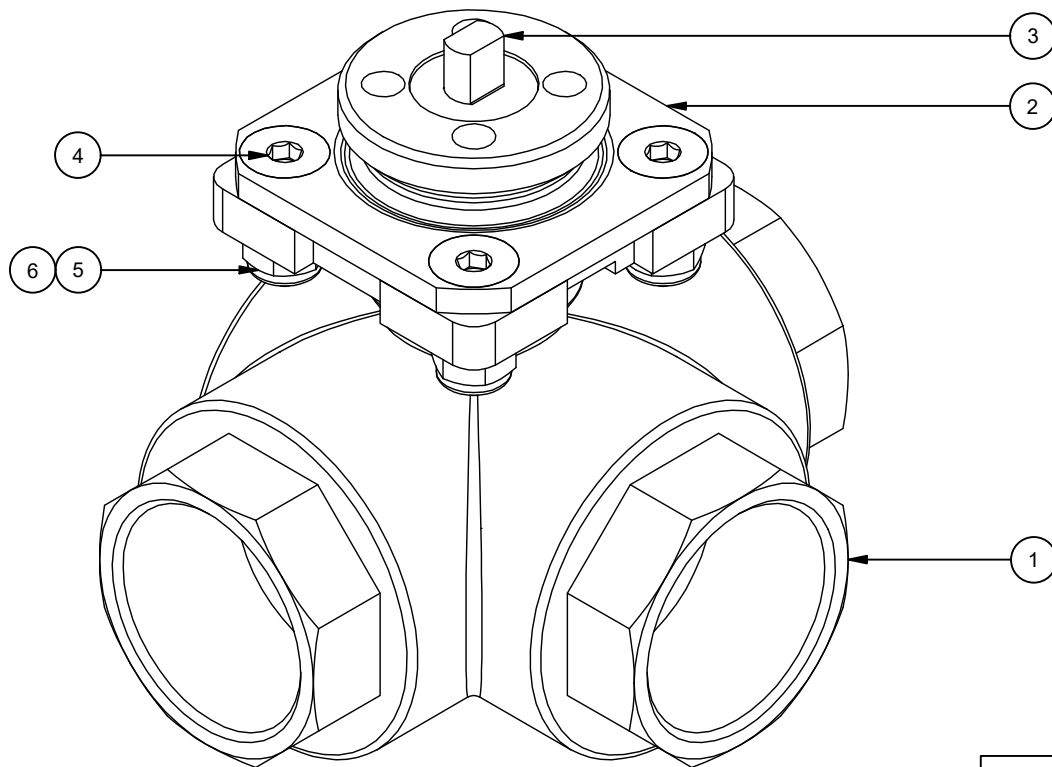

BOM			
Pos.	Qty.	Part	Description
1	1	GHN0000019	3-Way Valve 1 inch, 3 x IG, Stainless Steel , Orifice
2	1	PRS5233	Adapter Ø 63 mm, 15 mm
3	1	PRS5310	Receptacle Ø 22,5 mm, 18 mm
4	4	NSE.022.E	Countersunk Bolt M 6 x 20 mm ISO 10642
5	4	NMK.003.EE	Hexagon Nut M 6 , DIN 985
6	4	NUS.002.EE	Washer A Ø 6,4 mm x Ø 12 mm x 1,6 mm

Body Ball Valve  
3-Way Ball Valve

A00

GHN0000017

© Vogelsang GmbH & Co. KG

**Vogelsang**



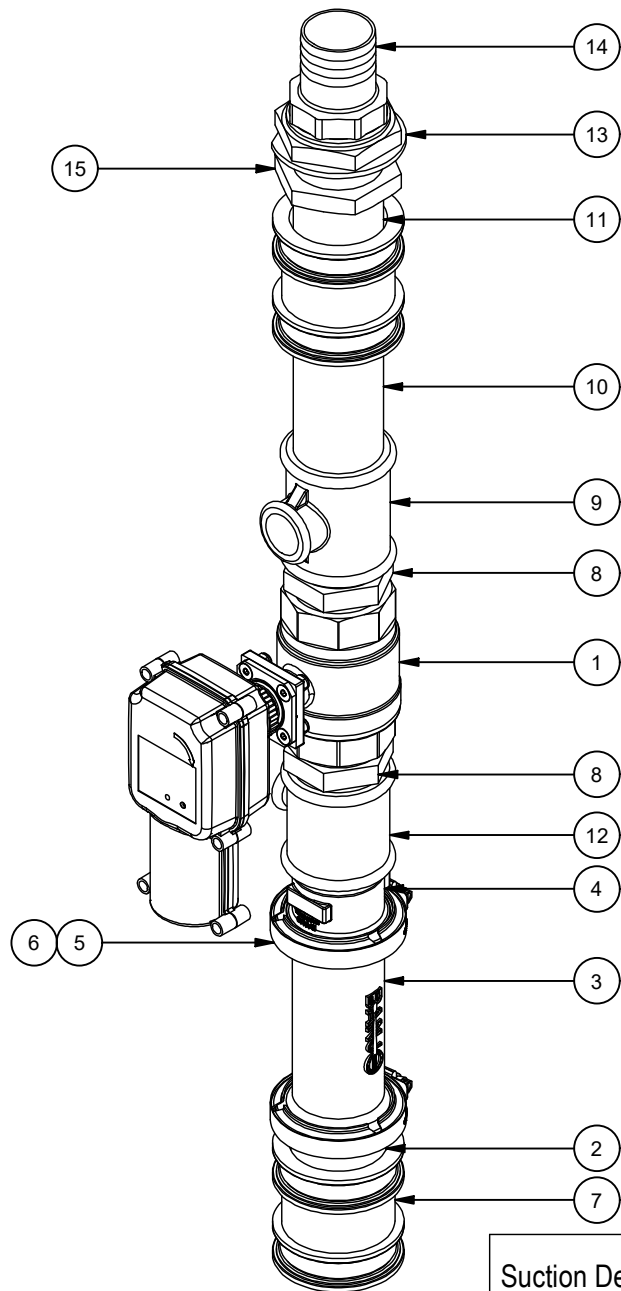

BOM			
Pos.	Qty.	Part	Description
1	1	GHN0187	2-Way Ball Valve 2 inch, IG - IG, Brass Electrical 12 V,
2	1	PRS4415	Turned Part, Raw Part Ø 83,1 mm x 65 mm
3	1	BNJ0011	Socket Banjo-Connection 2 inch
4	1	BNJ0014	Screw Connection Banjo-Connection 2 inch
5	2	BNJ0023	Clip Type: 220
6	2	BNJ0040	Gasket Type: M222G
7	2	DYD0010	Drainage Coupling Upmann FixUp
8	2	HRS.042	Double Pipe Nipple 2 inch x 65 mm,
9	1	HRS.501.T1	T-Fitting 90° 2 inch/ 1 inch/ 2 inch FT, Three Times
10	1	HRS0634	Pipe Nipple 2 inch x 165 mm,
11	1	HRS0635	Pipe Nipple 2 inch x 135 mm,
12	1	NGE0416	T-Fitting 90° 2 inch / 1/2 inch / 2 inch FT, Three Times
13	1	NUS0028	Distance washer Ø 61 mm x Ø 90 mm x 4 mm
14	1	NVE.035	Hose Tail FT 2 inch x Ø 50 mm
15	2	NVE.088	Pipe Nut G 2 inch , DIN 431 Form B

Suction Device  
Hose Tail DN 50

B00

IBA0001486

© Vogelsang GmbH & Co. KG

**VOGELSANG**



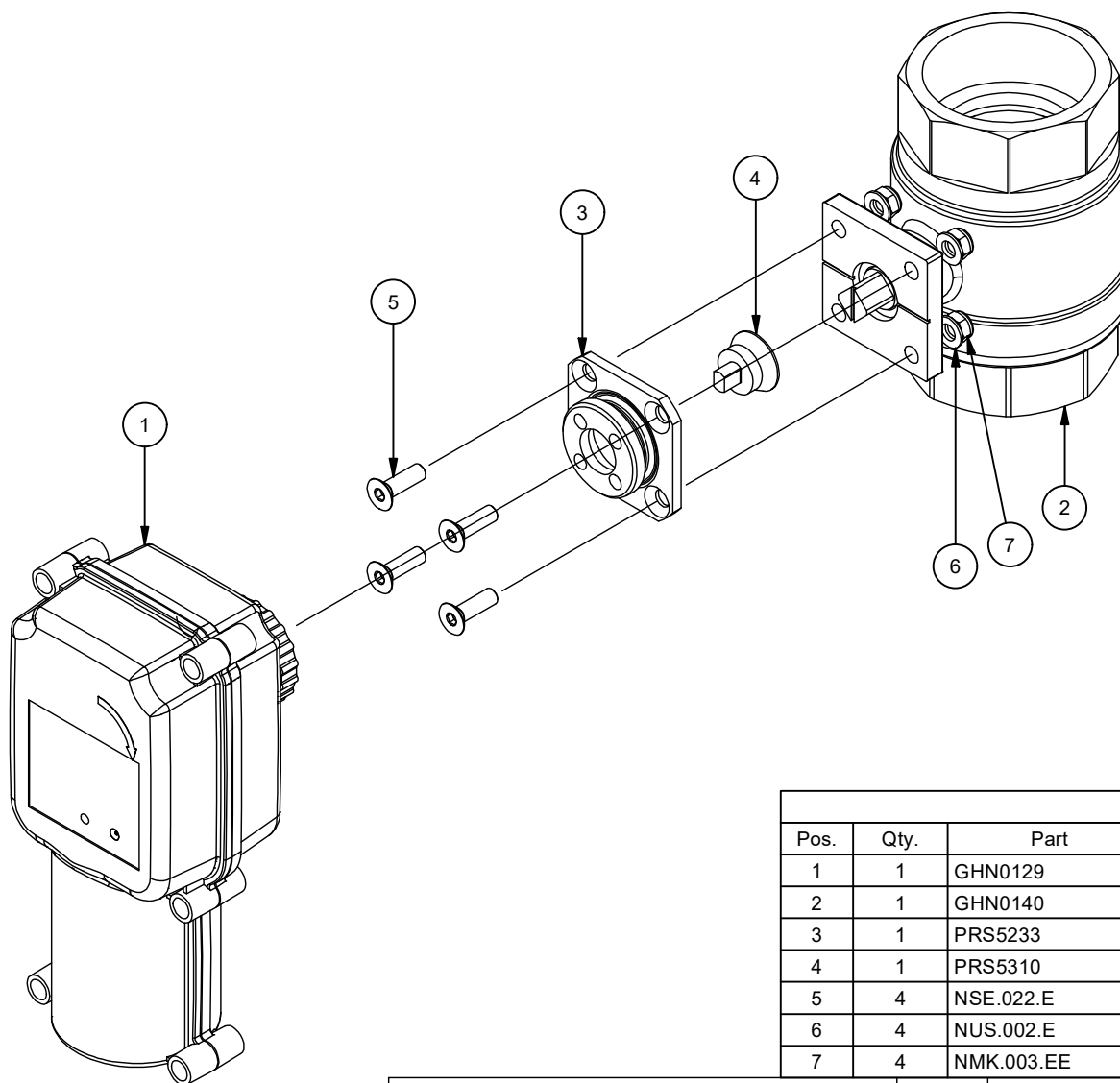

BOM			
Pos.	Qty.	Part	Description
1	1	GHN0129	Electrical Rotary Drive 12 V, IP 54
2	1	GHN0140	2-Way Ball Valve 2 inch, IG - IG, Brass Electrical 12 V,
3	1	PRS5233	Turned Part Adapter
4	1	PRS5310	Receptacle Ø 22,5 mm, 18 mm
5	4	NSE.022.E	Countersunk Bolt M 6 x 20 mm, ISO 10642
6	4	NUS.002.E	Washer A 6,4 mm x 12 mm x 1,6 mm
7	4	NMK.003.EE	Hexagon Nut M 6 , DIN 985

2-Way Ball Valve 2 inch, IG -  
IG, Brass Electrical 12 V,

C00

**GHN0187**

© Vogelsang GmbH & Co. KG

**VOGELSANG**



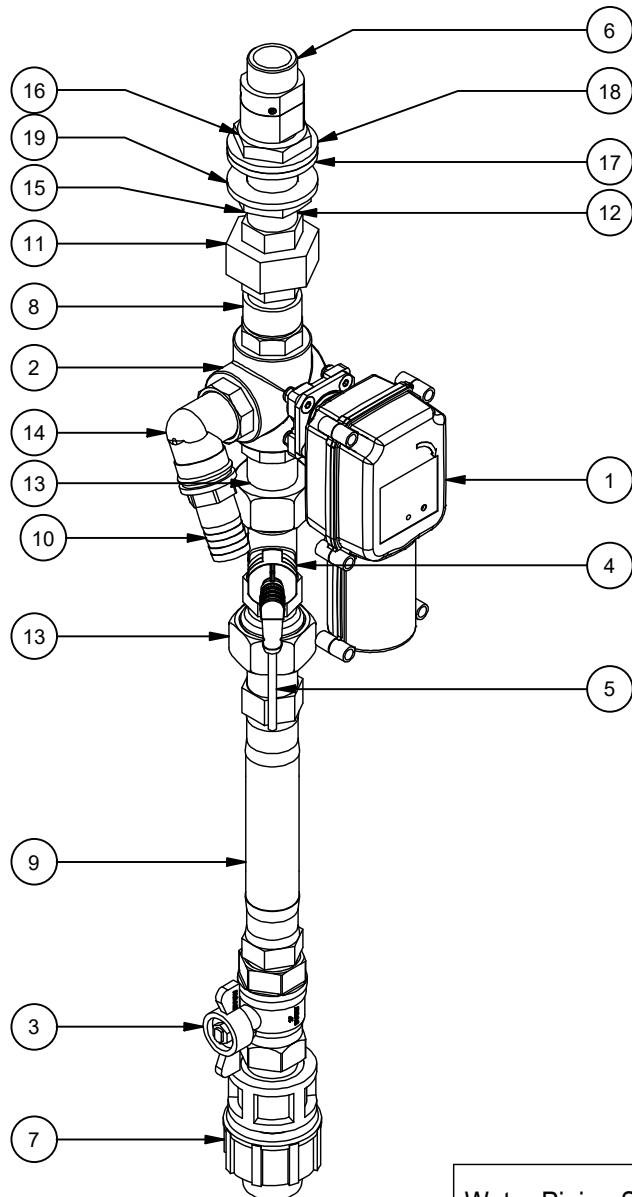

BOM			
Pos.	Qty.	Part	Description
1	1	GHN0129	Electrical Rotary Drive 12 V, IP54
2	1	GHN0000017	Body Ball Valve 3-Way Ball Valve
3	1	GHN0082	2-Way Ball Valve 1 inch, IG - IG, Brass Butterfly Handle,
4	1	SDW0000014	Flow Meter DN 25, MT 1 1/4 inch , Optional Plastics, Huba
5	1	EKK0196	Sensor-Actuator Patch Cord Number of poles: 5, 2,0 m
6	1	GDG0022	Swivel Joint Vogelsang DN 25, 1.4301
7	1	HPB0203	Clamp Connection Ø 32 mm - 1 inch
8	1	HRS.515	Tap Extension 1 inch FT-MT x 20 mm
9	1	HSC.059	Armoured Hose DN 25, 1 inch FT - MT
10	1	NVE.014	Hose Tail MT 1 inch x Ø 25 mm
11	1	NVE.039	Straight Coupling FT 1 inch - MT 1 inch
12	1	NVE.079	Pipe Nipple 1 inch x 100 mm,
13	2	NVE0159	Reducer 1 1/4 inch FT - 1 inch MT
14	1	NWE0000006	Angle 90° 1 inch FT - 1 inch MT
15	1	NVE.054	Pipe Nut G 1 inch , DIN 431 Form B
16	1	NVE.054.E	Pipe Nut G 1 inch , DIN 431
17	1	NUS0150	Washer A Ø 34 mm x Ø 60 mm x 5 mm
18	1	NUS0079	Washer B Ø 34 mm x Ø 60 mm x 5 mm
19	1	NUS.025	Washer B Ø 34 mm x Ø 60 mm x 5 mm

Water Piping Set  
Clamp Connection-Ø 32 mm

A00

IBA0001564

© Vogelsang GmbH & Co. KG

**VOGELSANG**





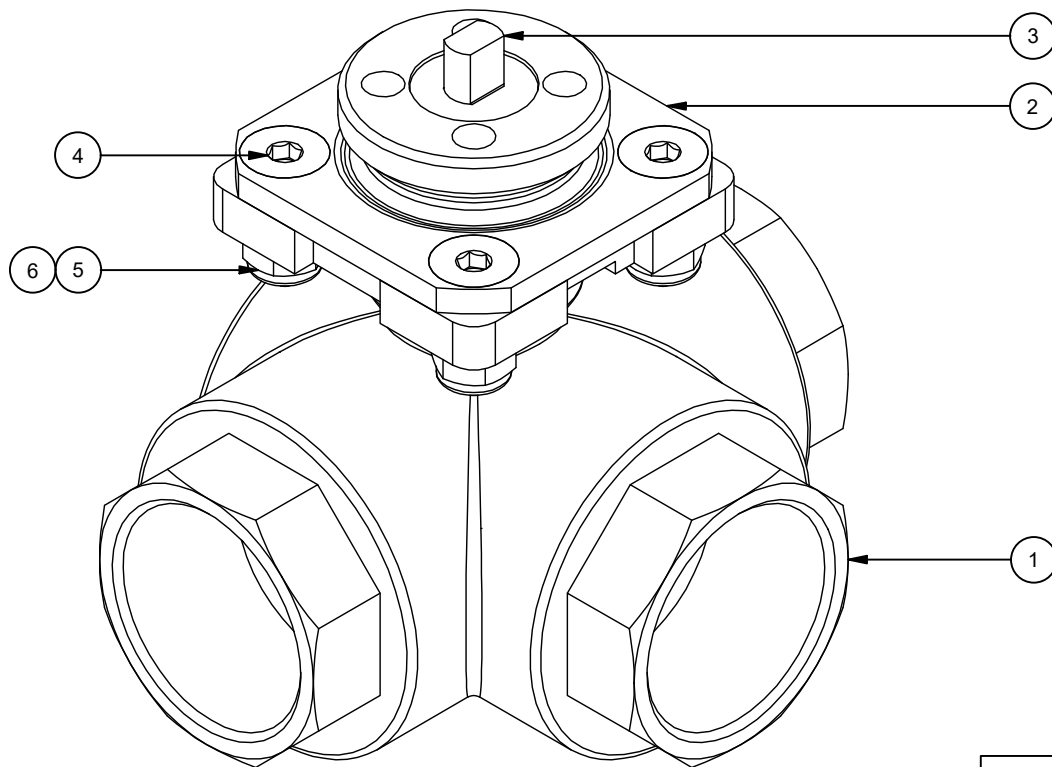

BOM			
Pos.	Qty.	Part	Description
1	1	GHN0000019	3-Way Valve 1 inch, 3 x IG, Stainless Steel , Orifice
2	1	PRS5233	Adapter Ø 63 mm, 15 mm
3	1	PRS5310	Receptacle Ø 22,5 mm, 18 mm
4	4	NSE.022.E	Countersunk Bolt M 6 x 20 mm ISO 10642
5	4	NMK.003.EE	Hexagon Nut M 6 , DIN 985
6	4	NUS.002.EE	Washer A Ø 6,4 mm x Ø 12 mm x 1,6 mm

Body Ball Valve  
3-Way Ball Valve

A00

GHN0000017

© Vogelsang GmbH & Co. KG

**VOGELSANG**



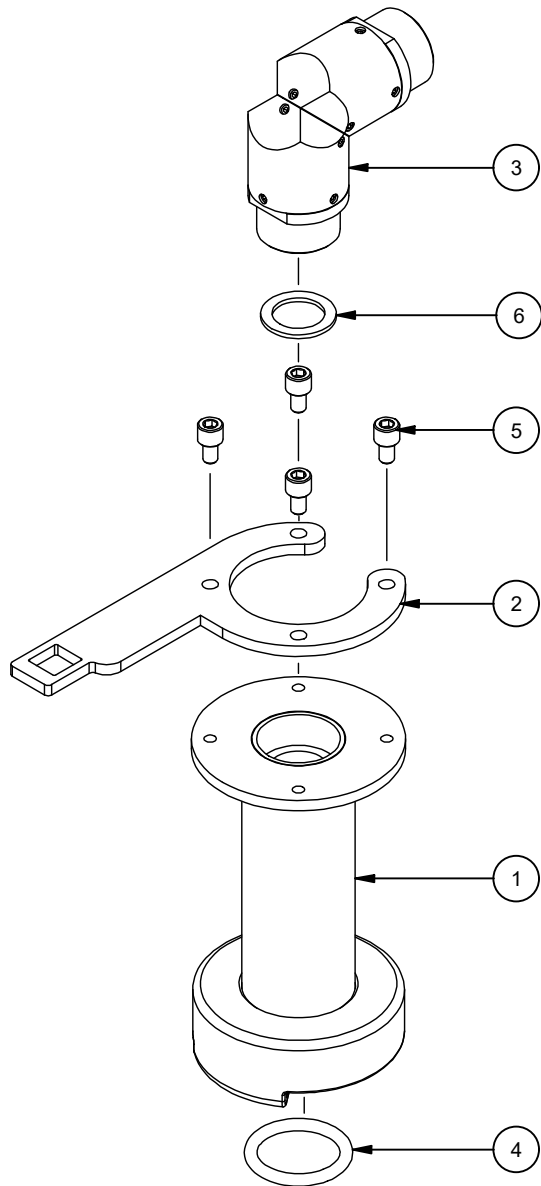

BOM			
Pos.	Qty.	Part	Description
1	1	IBS0595	Water Supply Coupling 1.4301
2	1	LFA0221	Laser-Cut Part Material Thickness 5 mm
3	1	GDG0019	Angular Swivel Joint Vogelsang Ø 22 mm, 1.4301
4	1	DOR.101	O-Ring Ø 33 mm x 5 mm
5	4	NSI.022	Cylinder Head Bolt M 6 x 10 mm, ISO 4762
6	1	DFD0298	Flat Gasket Pipeworks Non-Asbestos Fiber Material,

Water Supply Coupling  
EasyConnect Pro

E00

NYK.050.TH

© Vogelsang GmbH & Co. KG

**Vogelsang**



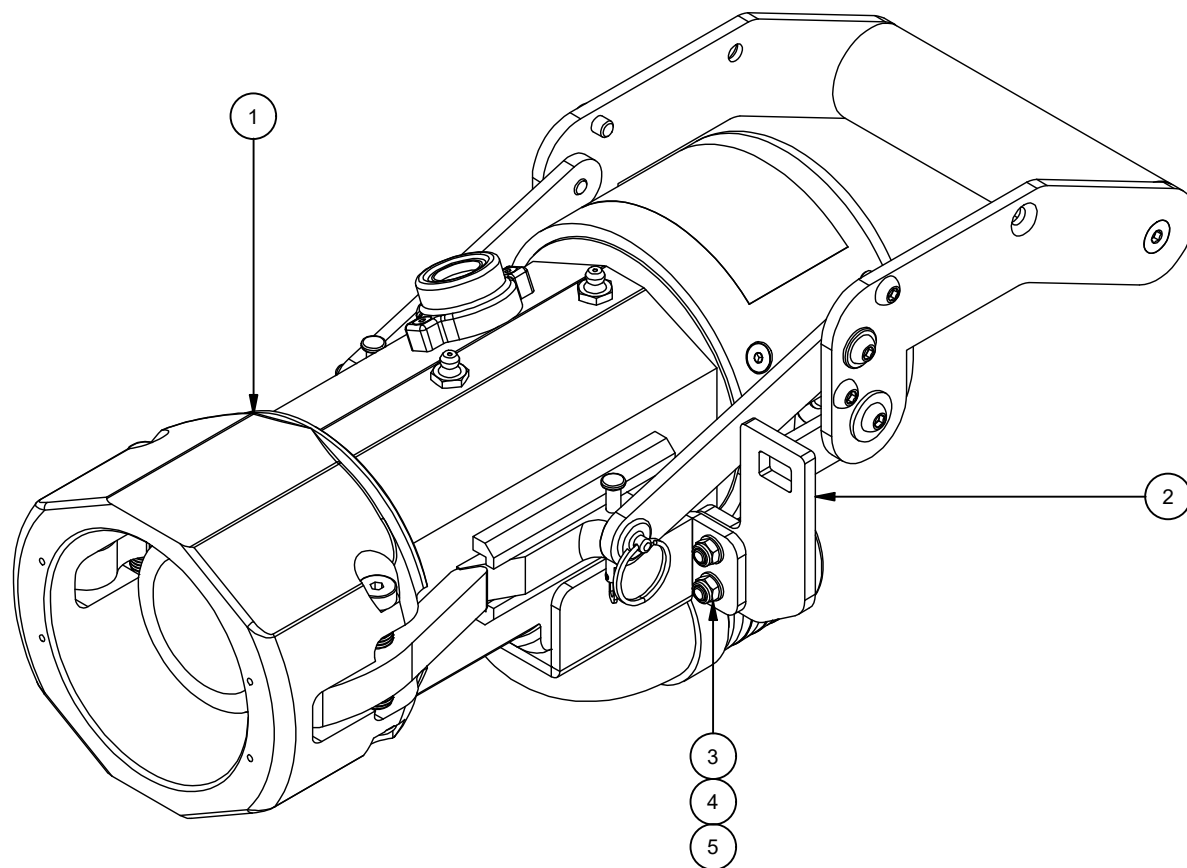

BOM			
Pos.	Qty.	Part	Description
1	1	NYK0000017	Suction coupling EasyConnect Pro Kamlock 3 inch
2	1	LFB2832	Laser-Cut Part Material Thickness 5 mm
3	2	NMK.034.EE	Hexagon Nut M 5 , DIN 985
4	2	NSE0009	Countersunk Bolt M 5 x 16 mm ISO 10642
5	2	NUS.120.E	Washer A Ø 5,3 mm x Ø 10 mm x 1 mm

Suction coupling EasyConnect  
Pro Kamlock 3 inch Stainless

B00

NYK0000021

© Vogelsang GmbH & Co. KG

**VOGELSANG**



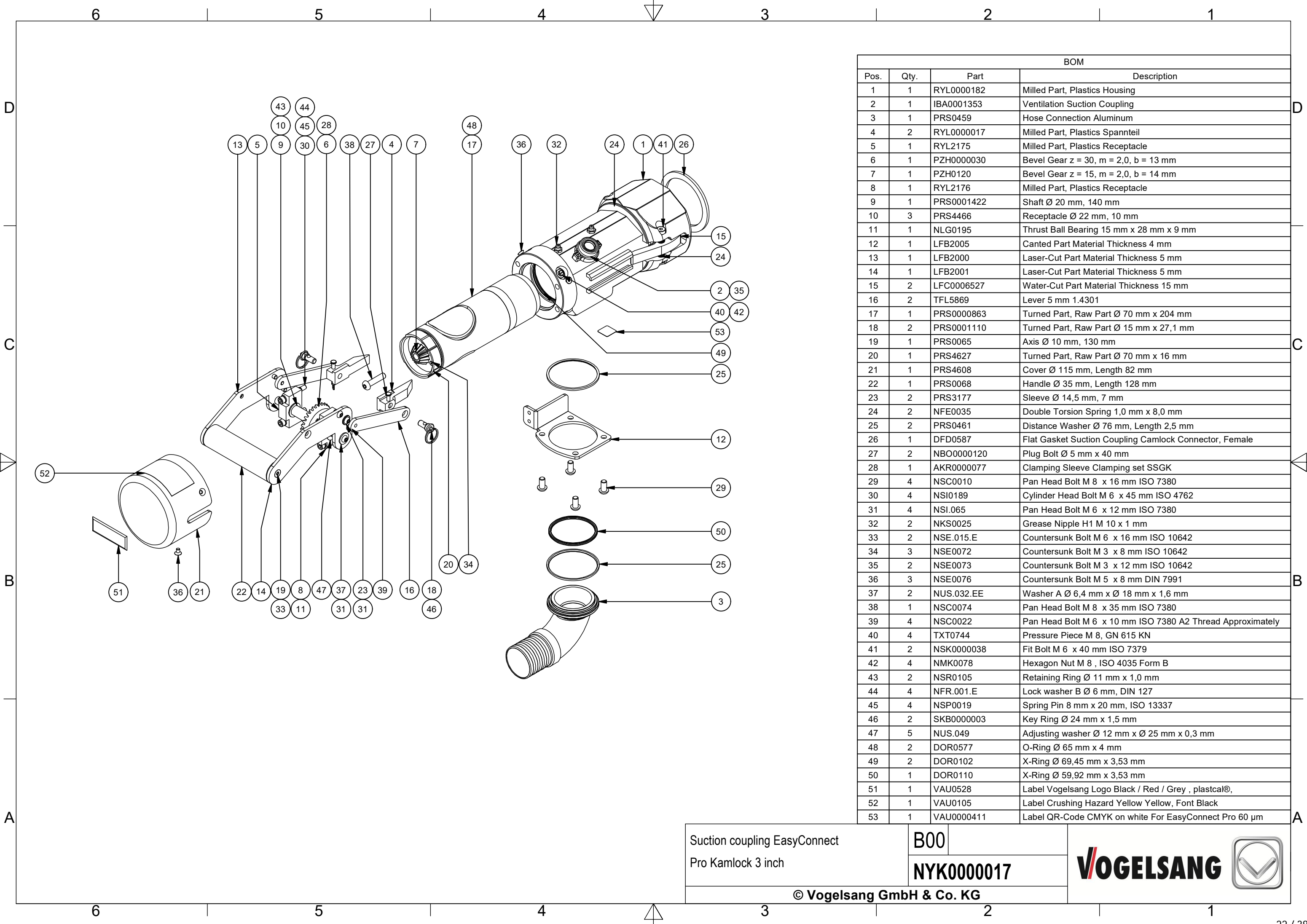

Suction coupling EasyConnect  
Pro Kamlock 3 inch

B00

NYK0000017

© Vogelsang GmbH & Co. KG

**VOGELSANG**

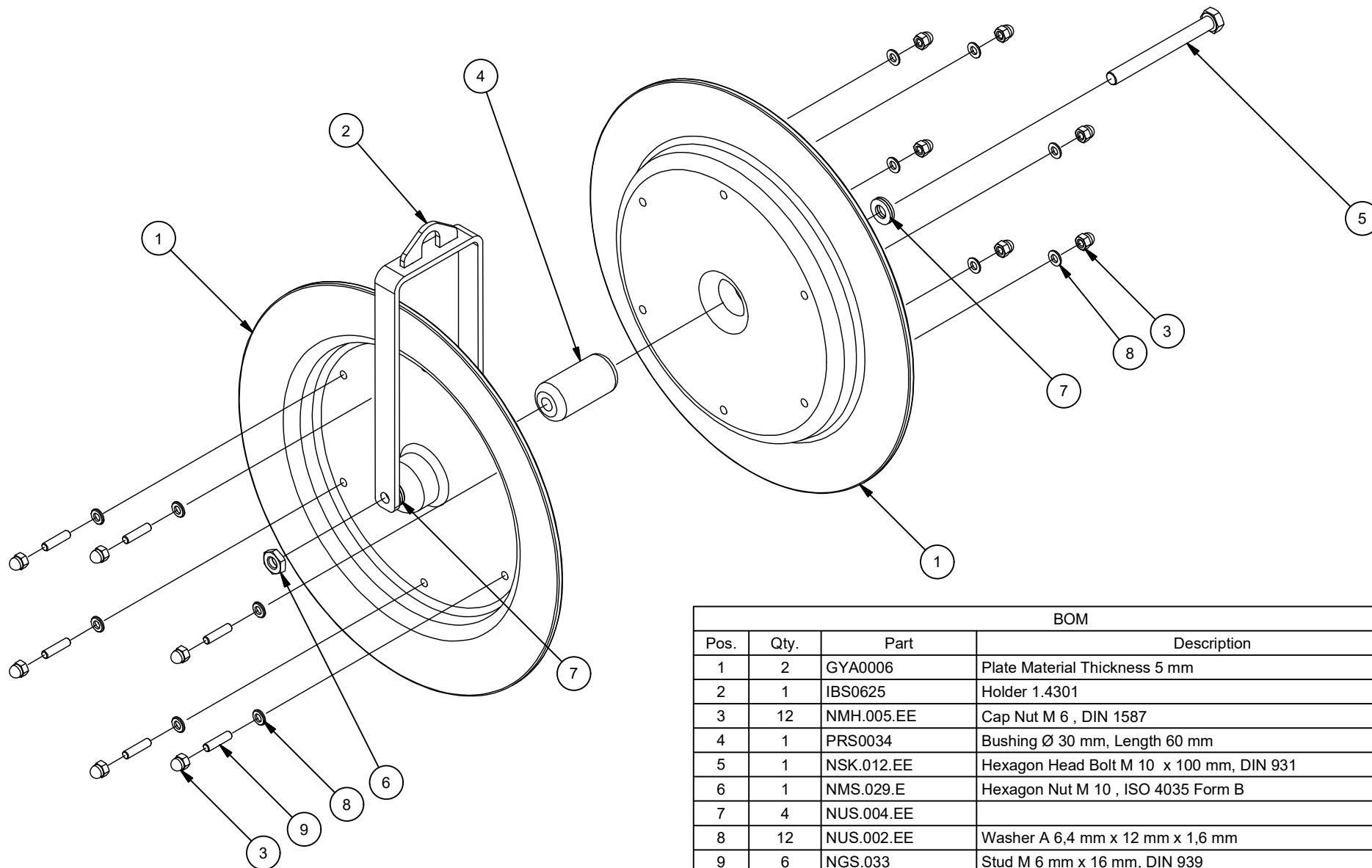

BOM			
Pos.	Qty.	Part	Description
1	2	GYA0006	Plate Material Thickness 5 mm
2	1	IBS0625	Holder 1.4301
3	12	NMH.005.EE	Cap Nut M 6 , DIN 1587
4	1	PRS0034	Bushing Ø 30 mm, Length 60 mm
5	1	NSK.012.EE	Hexagon Head Bolt M 10 x 100 mm, DIN 931
6	1	NMS.029.E	Hexagon Nut M 10 , ISO 4035 Form B
7	4	NUS.004.EE	
8	12	NUS.002.EE	Washer A 6,4 mm x 12 mm x 1,6 mm
9	6	NGS.033	Stud M 6 mm x 16 mm, DIN 939

Guide Pulley TUnit	D	
	GYA0010	
	© Vogelsang GmbH & Co. KG	

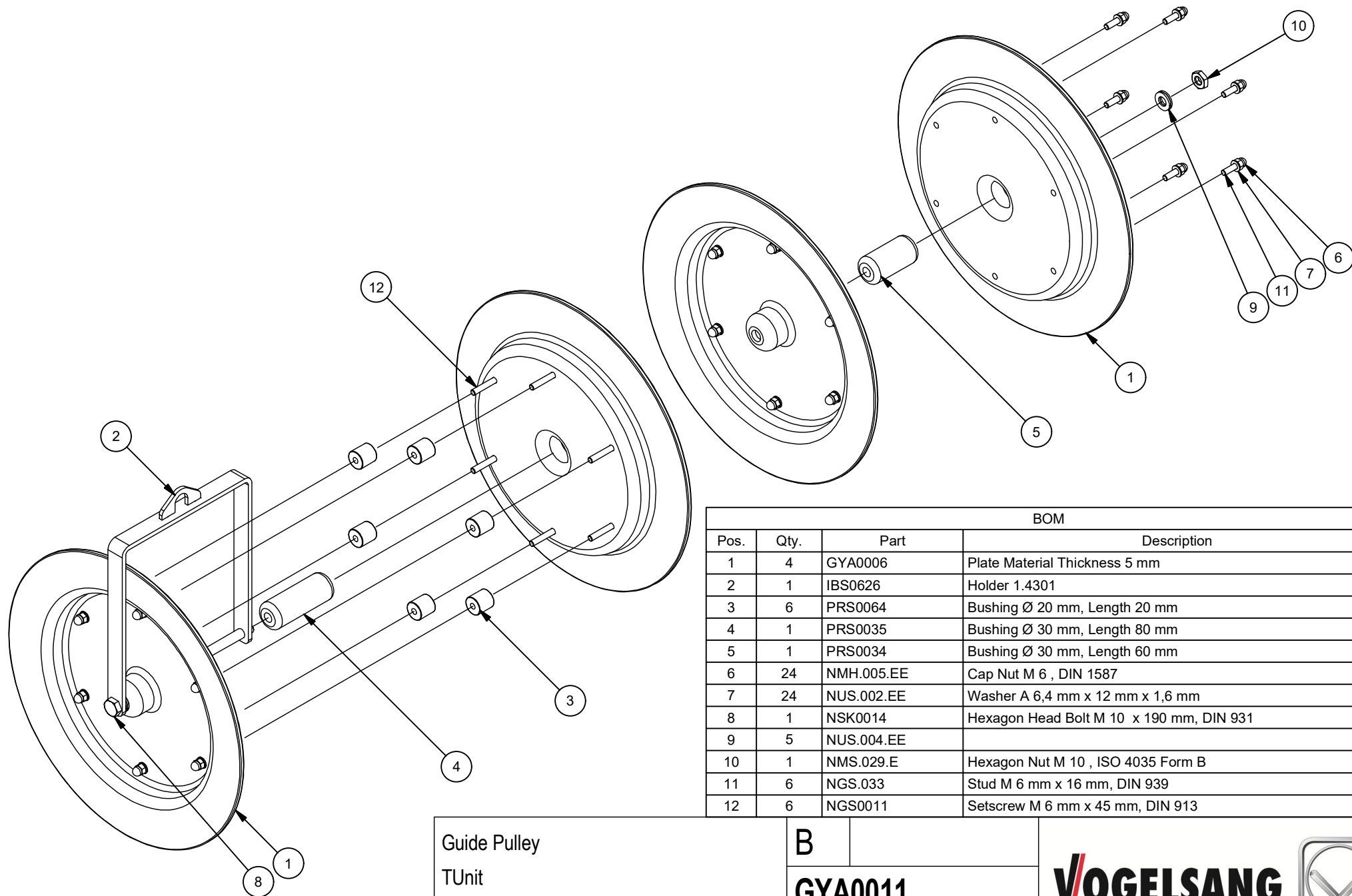

BOM			
Pos.	Qty.	Part	Description
1	4	GYA0006	Plate Material Thickness 5 mm
2	1	IBS0626	Holder 1.4301
3	6	PRS0064	Bushing Ø 20 mm, Length 20 mm
4	1	PRS0035	Bushing Ø 30 mm, Length 80 mm
5	1	PRS0034	Bushing Ø 30 mm, Length 60 mm
6	24	NMH.005.EE	Cap Nut M 6 , DIN 1587
7	24	NUS.002.EE	Washer A 6,4 mm x 12 mm x 1,6 mm
8	1	NSK0014	Hexagon Head Bolt M 10 x 190 mm, DIN 931
9	5	NUS.004.EE	
10	1	NMS.029.E	Hexagon Nut M 10 , ISO 4035 Form B
11	6	NGS.033	Stud M 6 mm x 16 mm, DIN 939
12	6	NGS0011	Setscrew M 6 mm x 45 mm, DIN 913

Guide Pulley

TUnit

B

GYA0011

© Vogelsang GmbH & Co. KG

**VOGELSANG**



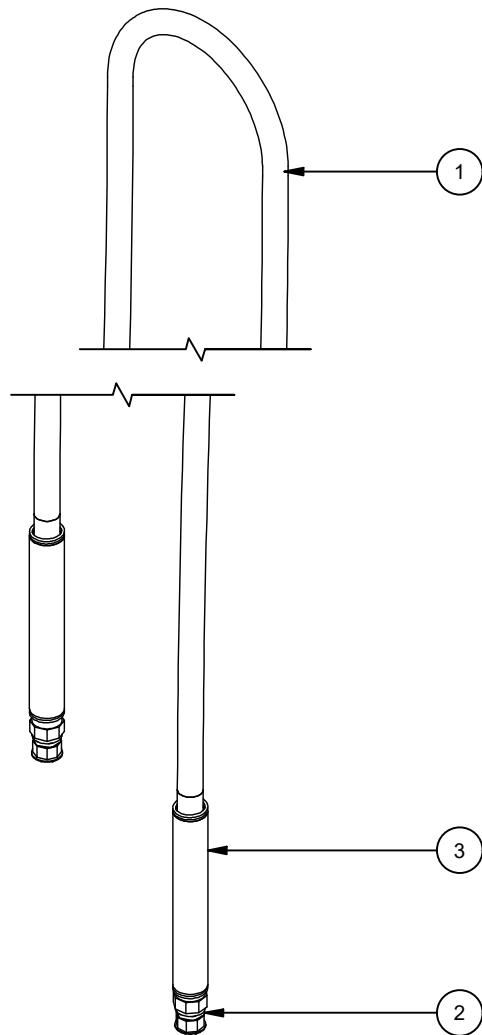

BOM			
Pos.	Qty.	Part	Description
1	1	HSC0000026	Hose Kit Water Hose, DN 25, 8,0 m
2	2	NVE.051.T1	Sleeve Fitting FT 1 inch x Ø 25 mm x 4,5 mm
3	2	NFE.037	Anti-Kink Spring 3,6 mm x 46,2 mm x 300 mm

Hose Kit Water Hose, DN 25, 7,8 m		A00	<b>VOGELSANG</b>
		GSC0000011	
© Vogelsang GmbH & Co. KG			



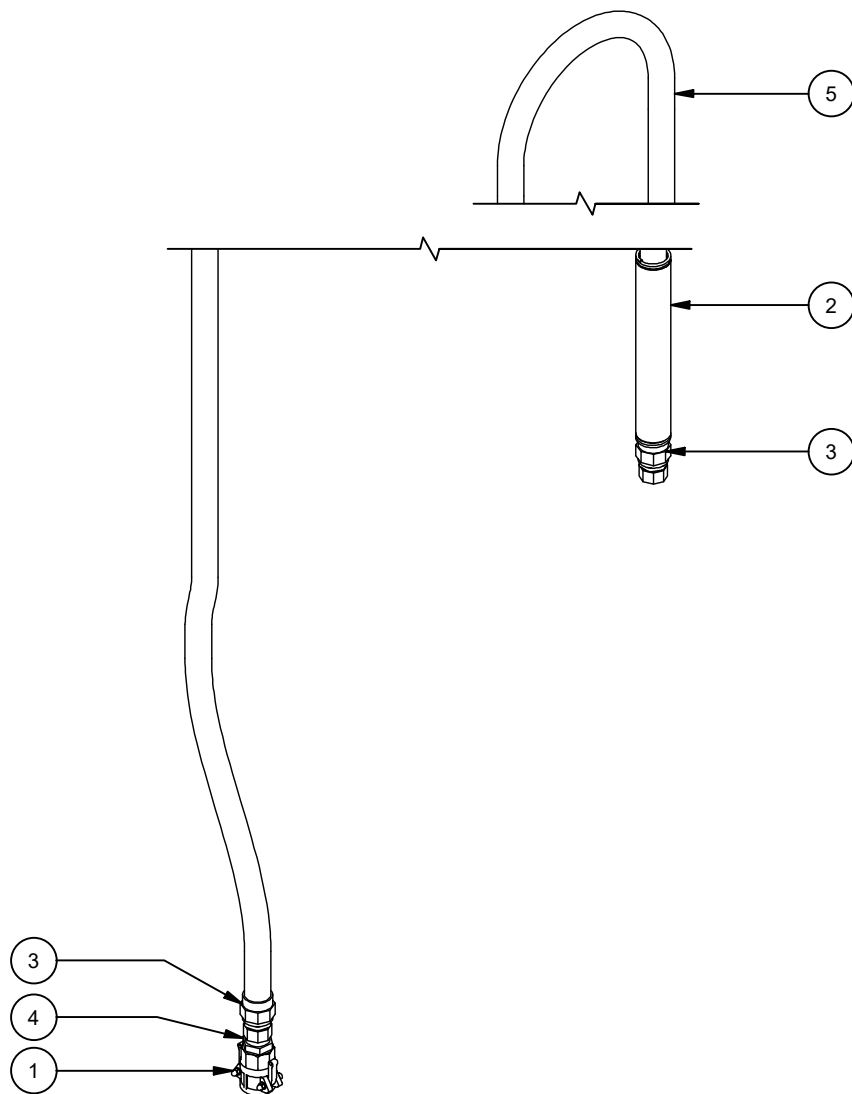

BOM			
Pos.	Qty.	Part	Description
1	1	NKU.019	KAMLOCK Coupling Female Coupling, D Type, FT 1 inch 1
2	1	NFE.037	Anti-Kink Spring 3,6 mm x 46,2 mm x 300 mm
3	2	NVE0213	Sleeve Fitting FT 1 inch x Ø 25 mm x 5 mm
4	1	HRS.500	Double Pipe Nipple 1 inch x 50 mm,
5	1	NYS.005	

Hose Kit  
Water Hose, DN 25, 8,5 m

A00

GSC0000012

© Vogelsang GmbH & Co. KG

**VOGELSANG**





BOM			
Pos.	Qty.	Part	Description
1	1	HSC0014	Spiral Hose Ø 50 mm x 5,5 mm, 8200 mm
2	2	NSS0004	Spiral Hose Clamp Maximum Clamping Range: 55 mm

Hose Kit  
Spiral Hose, DN 50, 8,2 m

A00

GSC0382

© Vogelsang GmbH & Co. KG

**VOGELSANG**



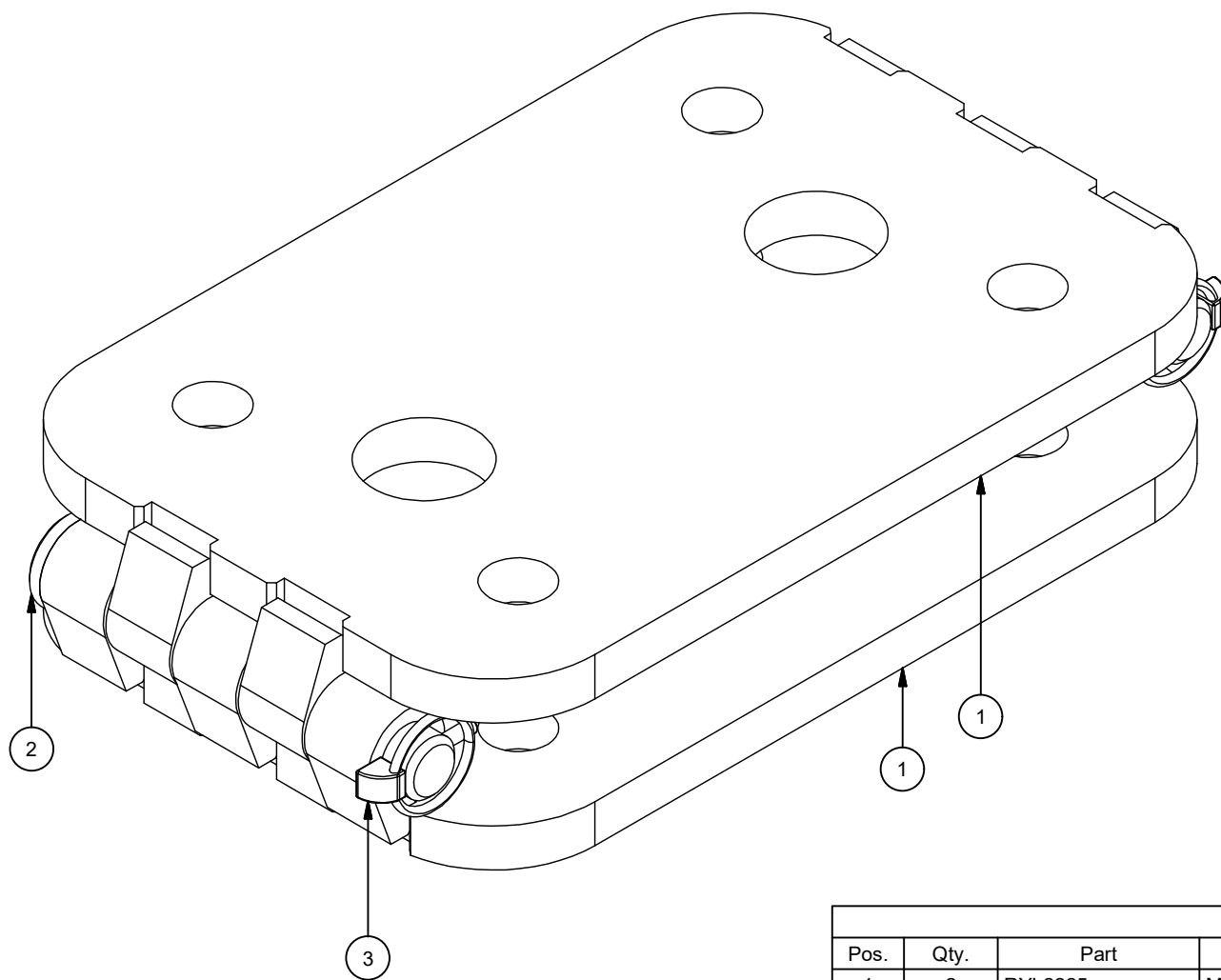

BOM			
Pos.	Qty.	Part	Description
1	2	RYL2225	Milled Part, Metal Adapter Plate
2	2	NBO0325	Bolt Ø 20 mm x 140 mm
3	2	NKL0006	Clip Pin Ø 4,5 mm x 32 mm

Swivel Adapter  
TUnit MP

A

IBA4578

© Vogelsang GmbH & Co. KG

**VOGELSANG**



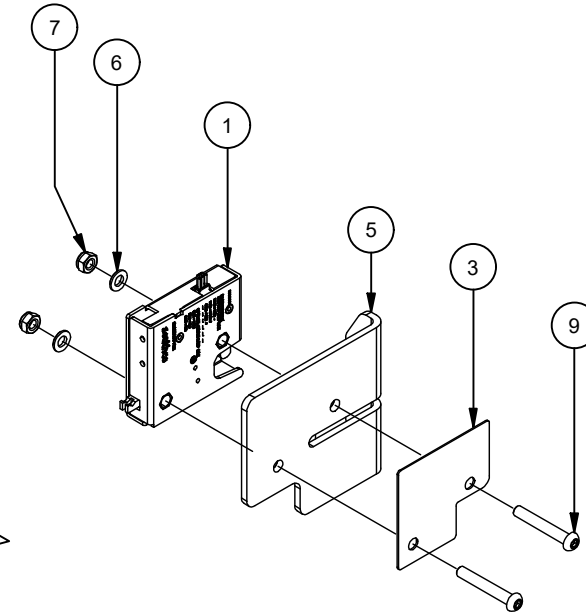
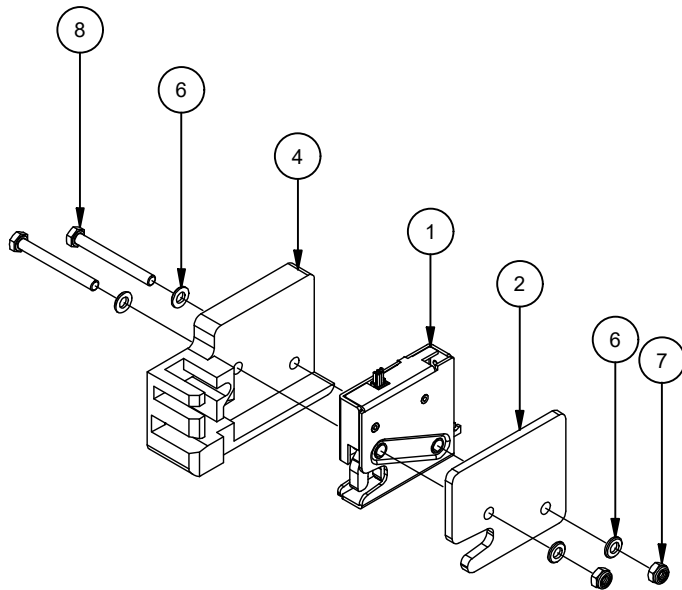

BOM			
Pos.	Qty.	Part	Description
1	2	EPM0694	Electrical Lock Interlocking Device
2	1	LFA0232	Water-Cut Part Material Thickness 5 mm
3	2	LFA1808	Water-Cut Part Material Thickness 1 mm
4	1	RYL1683	Milled Part, Plastics Holder
5	1	TFL6119	Guidance 4 mm 1.4301
6	6	NUS.002	Washer A 6,4 mm x 12 mm x 1,6 mm
7	4	NMK.003	Hexagon Nut M 6 , DIN 985
8	2	NSK.087	Hexagon Head Bolt M 6 x 55 mm, DIN 931
9	2	NSC0032	Pan Head Bolt M 6 x 40 mm, ISO 7380 Steel 10.9

Locking Set

TUnit MP

C00

IBA3347

© Vogelsang GmbH & Co. KG

**VOGELSANG**



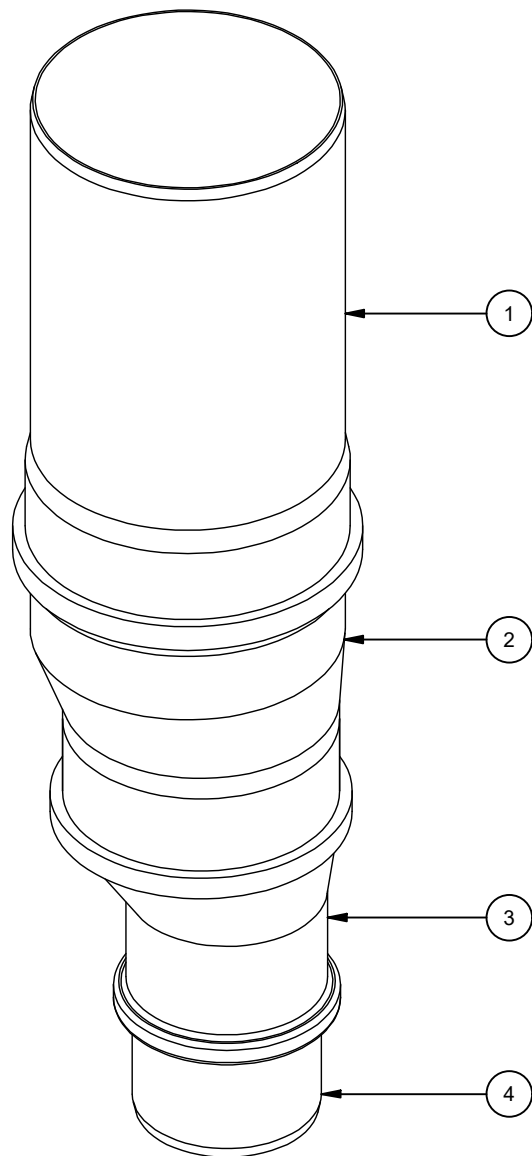

BOM			
Pos.	Qty.	Part	Description
1	1	HPZ0006	Sewer Pipe Ø 125 mm x 2,0 mm 150 mm
2	1	HPZ0003	Reducer Ø 125 mm x Ø 110 mm PP, Connecting Piece - Plug-In
3	1	HPZ0004	Reducer Ø 110 mm x Ø 75 mm PP, Connecting Piece - Plug-In
4	1	HPR0040	Sewer Pipe Ø 75 mm x 2,0 mm 150 mm

Pipeworks

TUnit MP

A00

IBA0001152

© Vogelsang GmbH & Co. KG

**VOGELSANG**



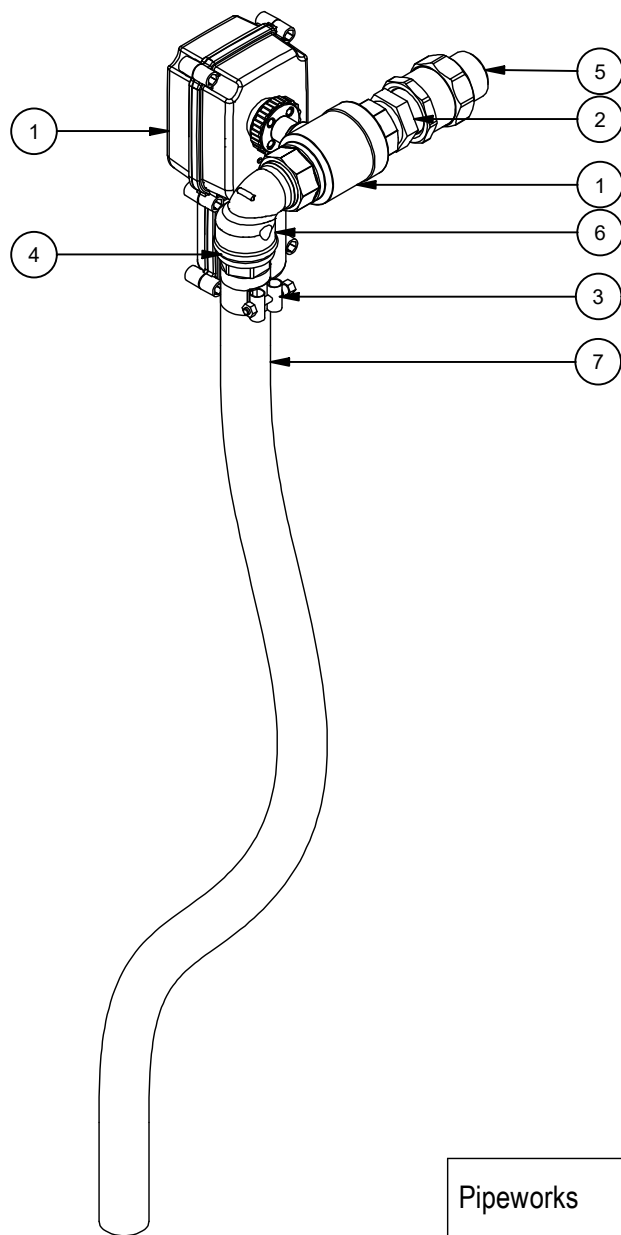

BOM			
Pos.	Qty.	Part	Description
1	1	GHN0125	2-Way Ball Valve 1 inch, IG - IG, Brass Electrical 12 V,
2	1	HRS.500	Double Pipe Nipple 1 inch x 50 mm,
3	1	NSS0069	Clamping Jaws Maximum Clamping Range: 35 mm
4	1	NVE.014	Hose Tail MT 1 inch x Ø 25 mm
5	1	NVE.039.T1	Straight Coupling FT 1 inch - MT 1 inch
6	1	NWE.207	Angle 90° 1 inch FT - 1 inch MT
7	1	HSC0203	

Pipeworks		C00	
TUnit MP		IBA4470	
© Vogelsang GmbH & Co. KG			

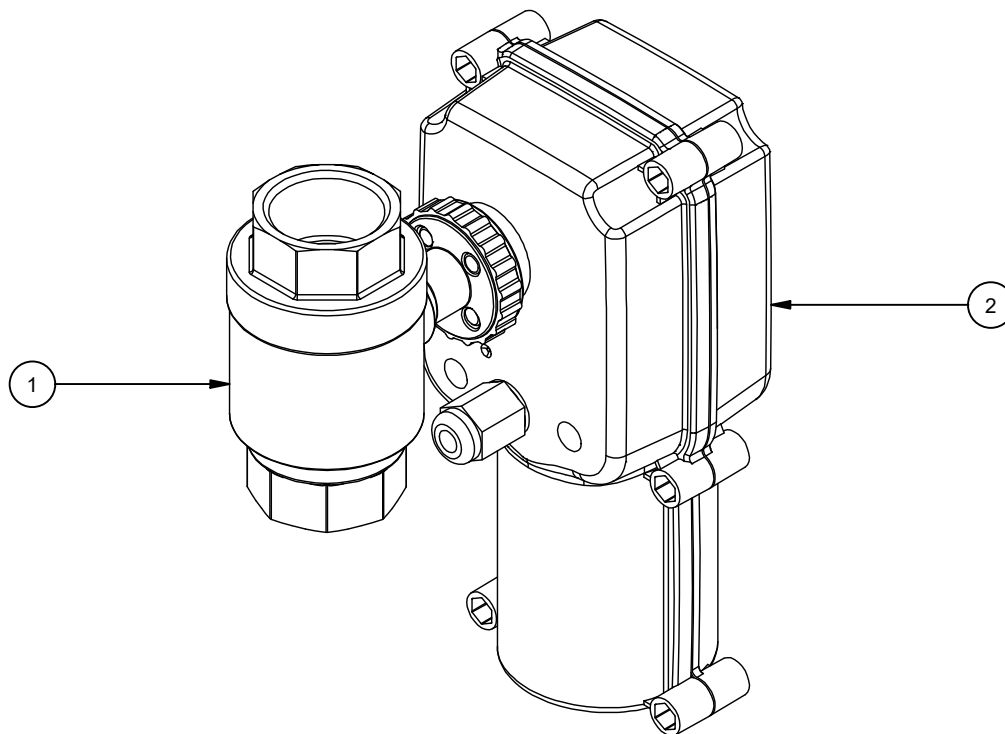

BOM			
Pos.	Qty.	Part	Description
1	1	GHN0075	Body Ball Valve 2-Way Ball Valve
2	1	GHN0129	Electrical Rotary Drive 12 V, IP 54

2-Way Ball Valve 1 inch, IG -  
IG, Brass Electrical 12 V,

B

GHN0125

© Vogelsang GmbH & Co. KG

**VOGELSANG**





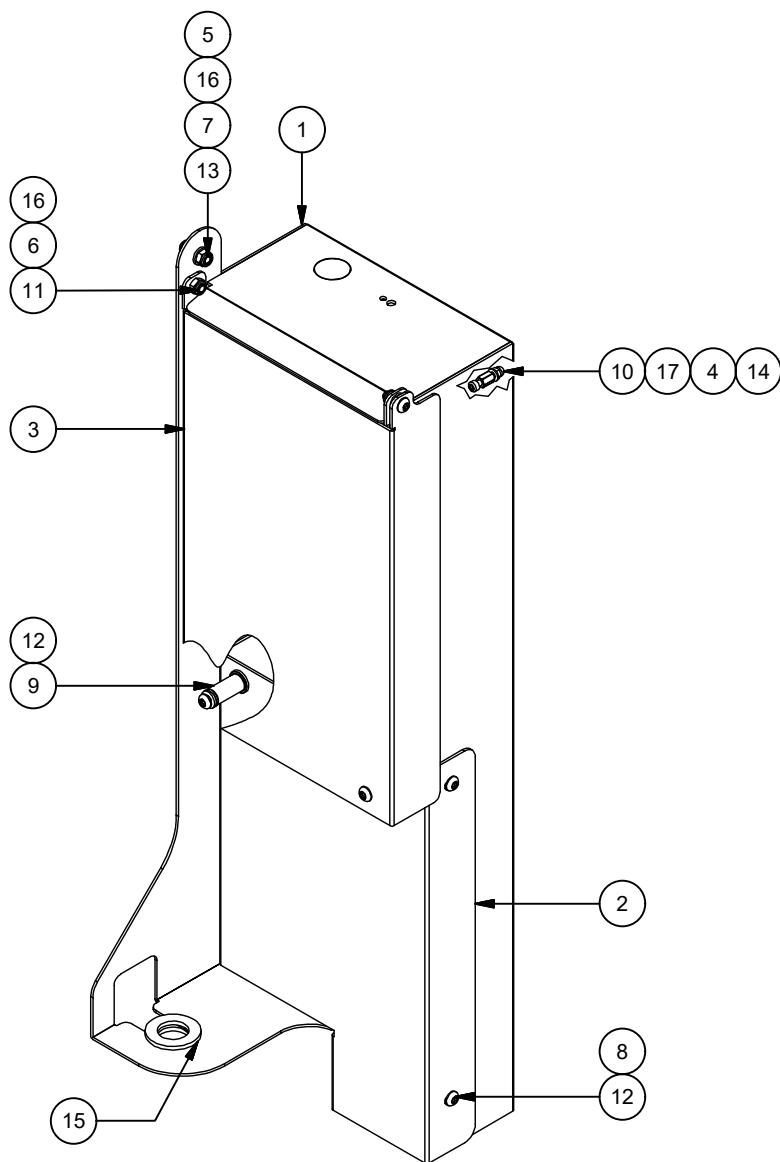

BOM			
Pos.	Qty.	Part	Description
1	1	TFL3321	Holder 2 mm 1.4301
2	1	TFL3520	Cover 2 mm 1.4301
3	1	TFL3320	
4	4	NMK0057	Hexagon Nut M 4 ,
5	1	NMK.003	Hexagon Nut M 6 , DIN 985
6	2	NMK.003.EE	Hexagon Nut M 6 , DIN 985
7	1	NMS.001	Hexagon Nut M 6 , DIN 934
8	3	NNM.002.E	Blind Rivet Nut Small Countersunk Head, M 6
9	2	NNM0013	Blind Rivet Nut Pan Head, M 6
10	4	NMH.006.E	Cap Nut M 4 , DIN 1587
11	1	NSI.065	Pan Head Bolt M 6 x 12 mm, ISO 7380
12	6	NSI.082	Pan Head Bolt M 6 x 16 mm, ISO 7380
13	1	NSI0031	Pan Head Bolt M 6 x 20 mm, ISO 7380
14	4	NSI0229	Cylinder Head Bolt M 4 x 20 mm, ISO 4762
15	4	NUS.008.P	Washer A 21,0 mm x 37 mm x 3,0 mm
16	9	NUS.100	Washer 6,4 mm x 12 mm x 1,6 mm
17	4	NUS.069.EE	Washer A 4,3 mm x 9 mm x 0,8 mm

Holder  
TUnit MP

E

IBA2631

© Vogelsang GmbH & Co. KG

**VOGELSANG**



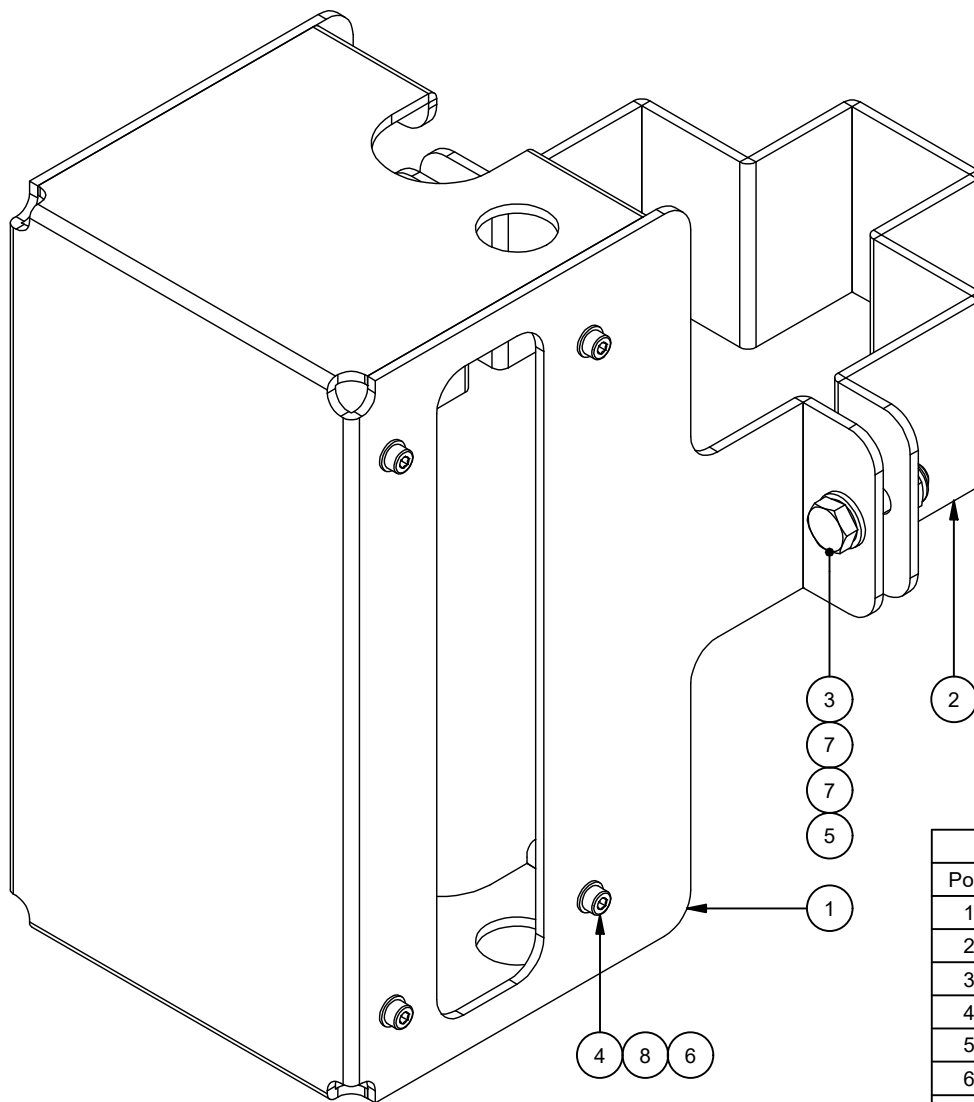

BOM			
Pos.	Qty.	Part	Description
1	1	TFL0002491	Fixing Sheet 3 mm 1.0976
2	1	TFL0002474	Holding Bow 3 mm 1.0976
3	2	NSK.020	Hexagon Head Bolt M 8 x 30 mm DIN 933
4	4	NSI0279	Cylinder Head Bolt M 4 x 16 mm ISO 4762
5	2	NMK.004	Hexagon Nut M 8 , DIN 985
6	4	NNM0000003	Blind Rivet Nut Small Countersunk Head, M 4
7	4	NUS.003	Washer A Ø 8,4 mm x Ø 16 mm x 1,6 mm
8	4	NUS.069	Washer A Ø 4,3 mm x Ø 9 mm x 0,8 mm

Lamp holder  
TUnit MP/TUnit SP

B00

IBA0001507

© Vogelsang GmbH & Co. KG

**Vogelsang**



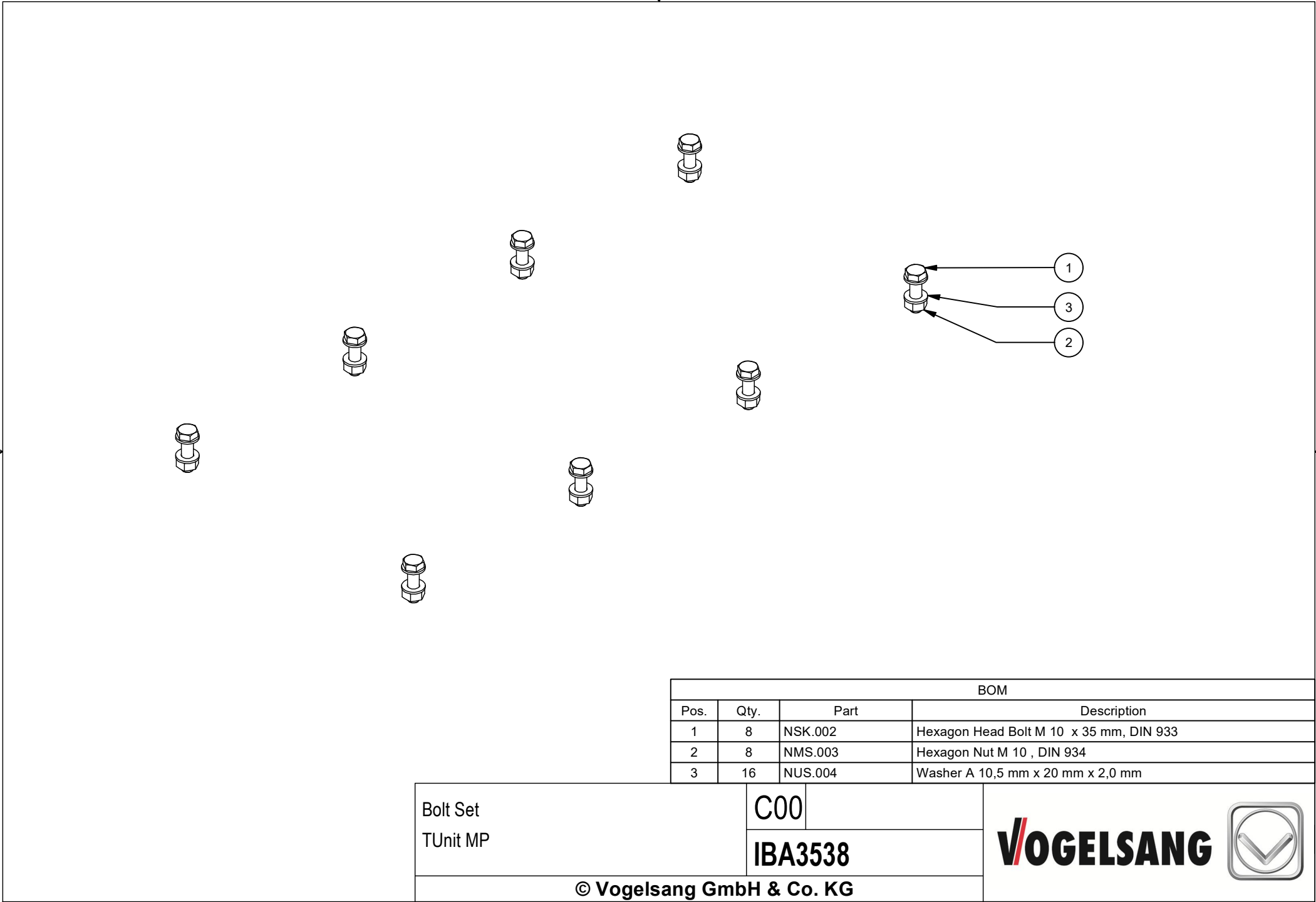

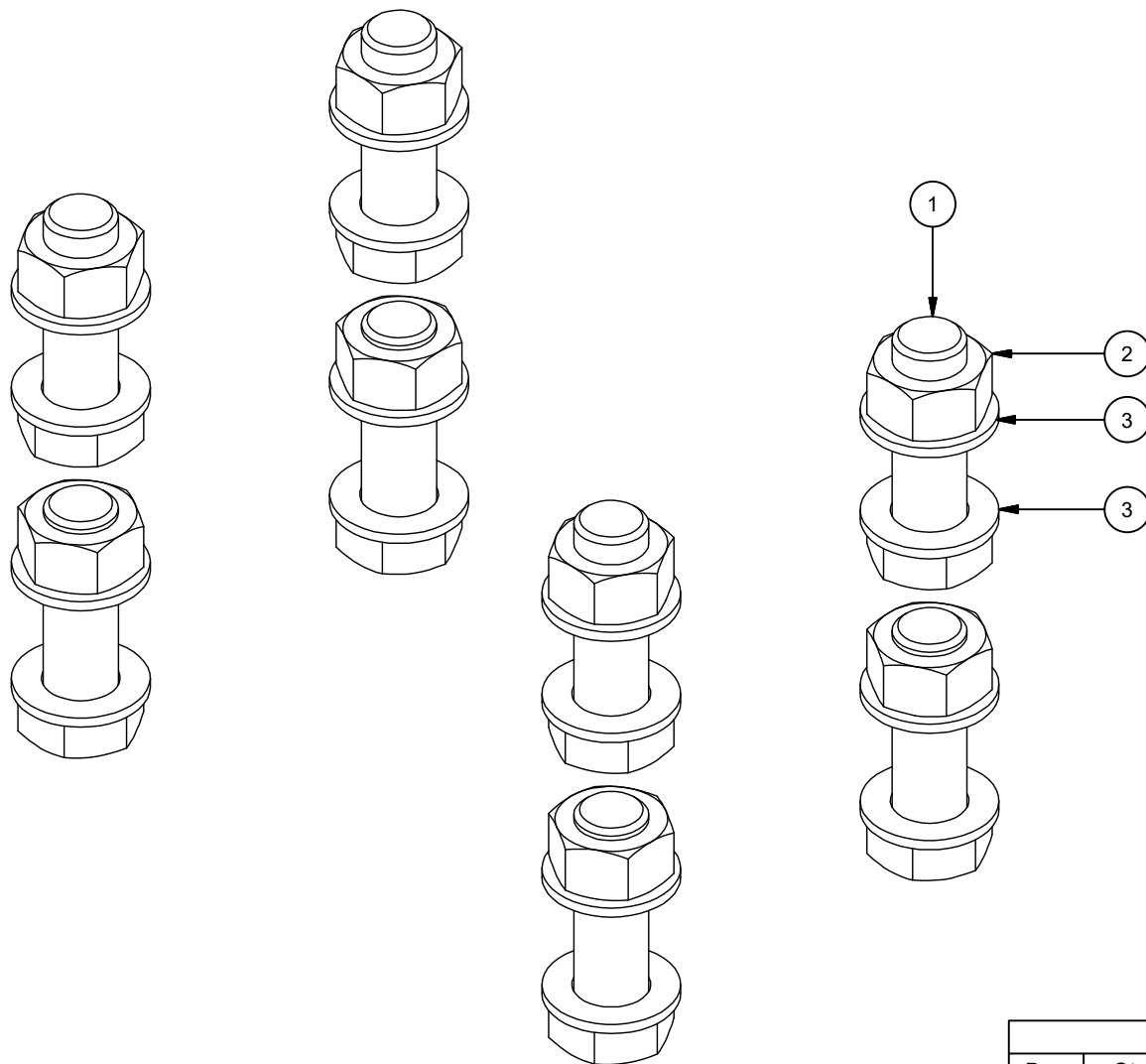

BOM			
Pos.	Qty.	Part	Description
1	8	NSK0012	Hexagon Head Bolt M 20 x 60 mm, DIN 933
2	8	NMS.007	Hexagon Nut M 20 , DIN 934
3	16	NUS.008	Washer A 21,0 mm x 37 mm x 3,0 mm

Bolt Set

TUnit MP/SP

A

IBA4542

© Vogelsang GmbH & Co. KG

**VOGELSANG**



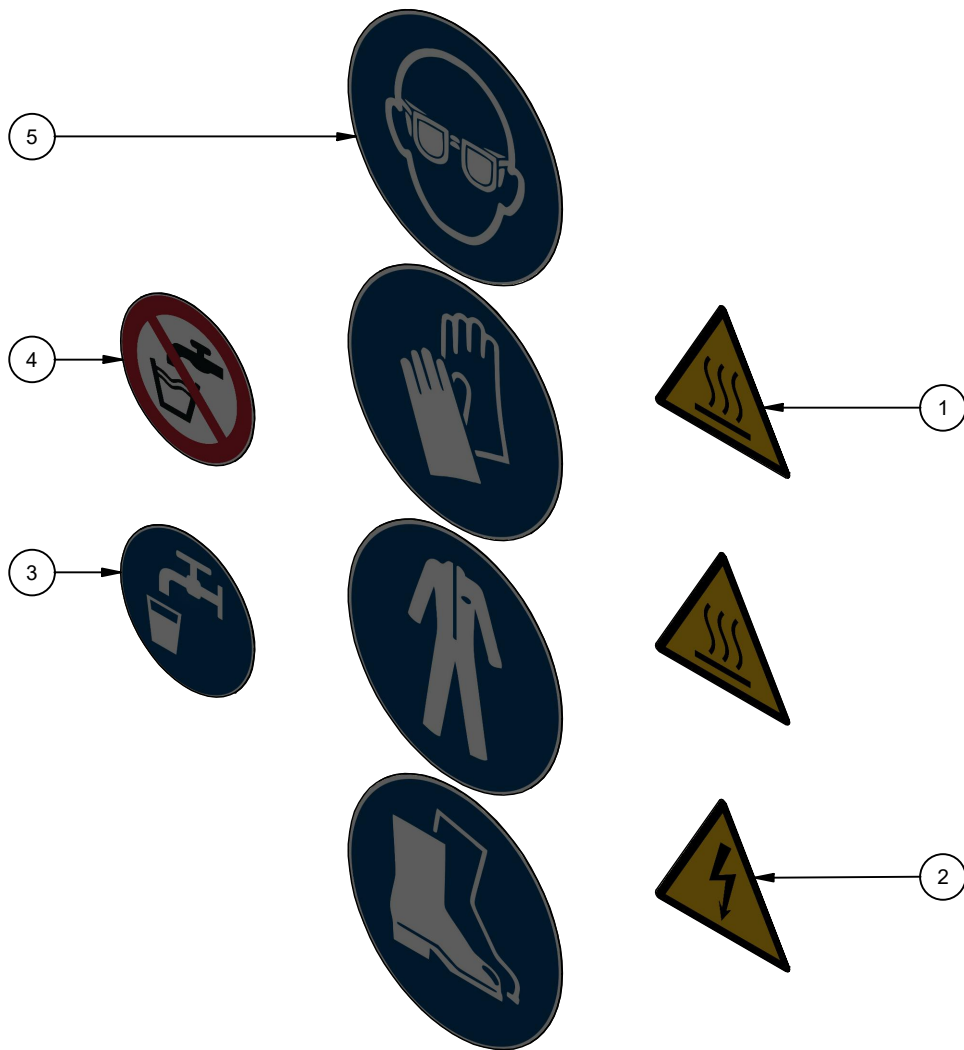

BOM			
Pos.	Qty.	Part	Description
1	2	VAU0121	Label Hot Surface Yellow Yellow, Font Black,
2	1	VAU0216	Label Caution: High Voltage! Gelb/Schwarz -40 °C - +100 °C,
3	1	VAU0218	Label Potable Water Blau/Weiß UV-stabil,
4	1	VAU0219	Label No Potable Water Weiß/Rot/Schwarz , , Highly
5	1	VAU0262	Label Attention protective clothes Blau/Weiß Aufkleber

Sticker Parts Kit TUnit MP Plus / Pro	D	<b>VOGELSANG</b>	
	VAU0223		
	© Vogelsang GmbH & Co. KG		

**Vogelsang GmbH & Co. KG**

Holthöge 10-14, 49632 Essen (Oldenburg), GERMANY

Phone: +49 (0) 5434 83 83 83  
+49 (0) 5434 83 99 99

Fax: +49 (0) 5434 83 10

[service@vogelsang.info](mailto:service@vogelsang.info)  
[www.vogelsang.info](http://www.vogelsang.info)**Vogelsang Lutherstadt Eisleben**

Gewerbegebiet Rothenschirmbach Nr. 8, 06295 Lutherstadt Eisleben, GERMANY

Phone: +49 (0) 34776 91 92 14

Fax: +49 (0) 34776 91 92 60



Subject to change without notice. Schematic drawings without claim to completeness.